

OFFICE OF THE
DOUGLAS COUNTY SURVEYOR

Station: SMTL T 27 S, R 5 W, Sec 19

Set By (Agency): CITY (RSBG)

Date Set: ?

Recovered By JP, TP

Date Recovered 8/82

Recovered By _____

Date Recovered _____

Recovered By _____

Date Recovered _____

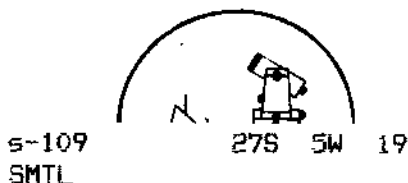
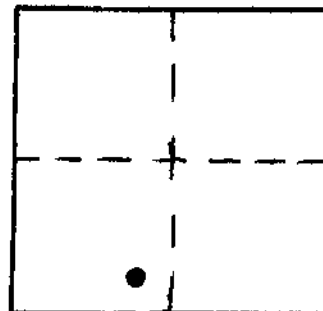

NAD 572369.04 4164312.52
83 43°12' 7" 123°20'23"

VERTICAL CONTROL

Elevation: _____ NGS Line # _____ USGS Line # _____ OSHD Line # _____

Precision: _____ Agency: _____ Proj. # _____ Date: _____

HORIZONTAL CONTROL OCS 27

South Zone State Plane Coordinates: Y(Northing) 572,404.26 X(Easting) 1,243,354.18

Precision: 1/20,000 Agency: DCSO Proj. # 2005-2 Date: 1983

Approximate Geographic Position: Latitude 43°12'08" Longitude 123°20'18"

DESCRIPTION and TO REACH

SKETCH

DESCRIPTION:

A brass cap street monument set below pavement with access cover above.

TO REACH:

Go to intersection of SE Laurel Dr. and SE Terrace Dr.

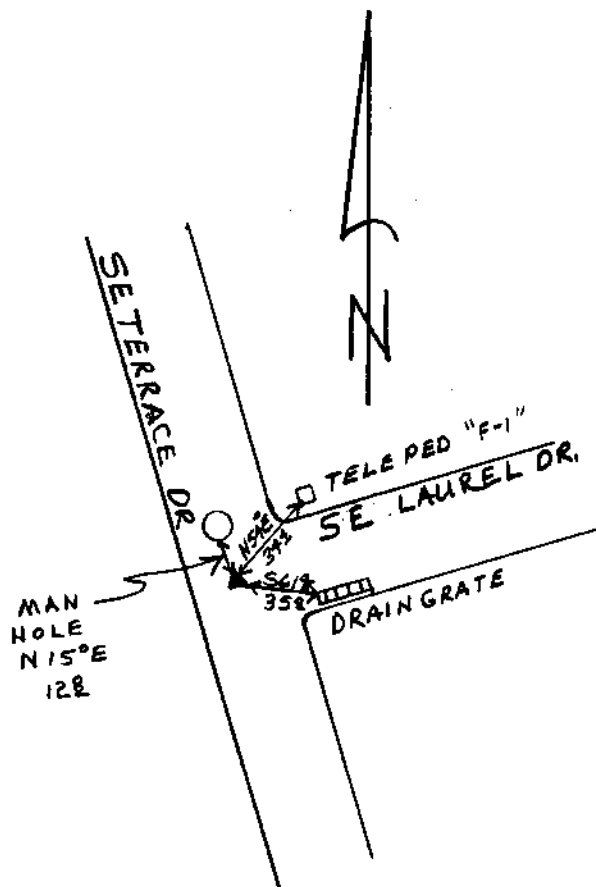

Reference Marks:

Note: For further information, contact the Douglas County Surveyor's Office, Room 205 Douglas County Justice Building, Roseburg, OR 97470. Phone 440-4278. Douglas County residents outside the Roseburg calling area, dial toll free 1-800-452-0991.