

OFFICE OF THE
DOUGLAS COUNTY SURVEYOR

Station: SMSS-2
 Set By (Agency): CITY (RSBG)
 Date Set: ?
 Recovered By JP, TP
 Date Recovered 8/82
 Recovered By _____
 Date Recovered _____
 Recovered By _____
 Date Recovered _____

T 27 S, R 5 W, Sec 19

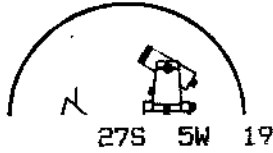

s-107
SMSS-2

NAD 571735.32 4165231.86
 83 43°12' 1" 123°20'10"

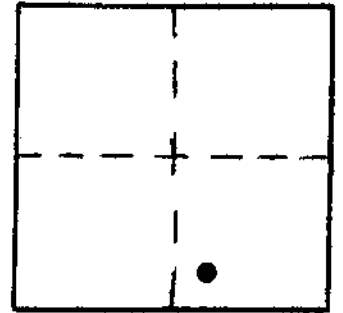

VERTICAL CONTROL

Elevation: _____ NGS Line # _____ USGS Line # _____ OSHD Line # _____
 Precision: _____ Agency: _____ Proj. # _____ Date: _____

HORIZONTAL CONTROL **OCS 27**

South Zone State Plane Coordinates: Y(Northing) 571,770.55 X(Easting) 1,244,273.52
 Precision: 1/20,000 Agency: DCSO Proj. # 2005-2 Date: 1983
 Approximate Geographic Position: Latitude 43°12'02" Longitude 123°20'06"

DESCRIPTION and TO REACH

SKETCH

DESCRIPTION:

DESCRIPTION:

A disk street monument set below pavement with access cover above.

TO REACH:

From the intersection of SE Terrace Dr. and SE Summit Dr. proceed southerly on SE Summit Dr. 0.20 miles to monument in centerline of road.

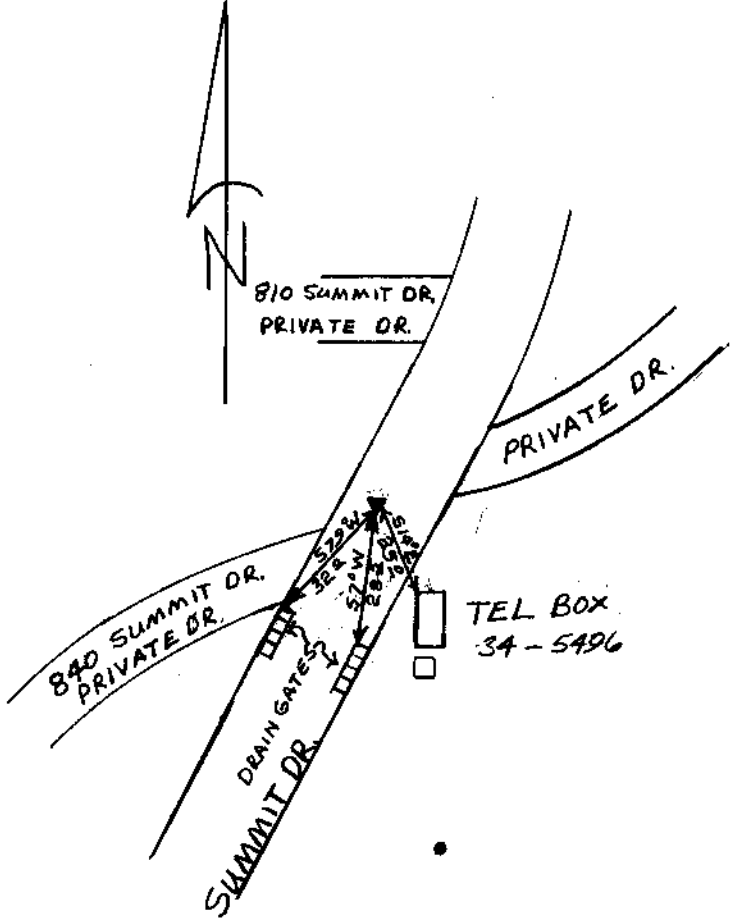

Reference Marks:

Note: For further information, contact the Douglas County Surveyor's Office, Room 205 Douglas County Justice Building, Roseburg, OR 97470. Phone 440-4278. Douglas County residents outside the Roseburg calling area, dial toll free 1-800-452-0991.