

OFFICE OF THE  
DOUGLAS COUNTY SURVEYOR

Station: SHAWN  
 Set By (Agency): DCSO  
 Date Set: 1980  
 Recovered By RWS, SIF  
 Date Recovered 11/20/84  
 Recovered By TF  
 Date Recovered 2-5-92  
 Recovered By \_\_\_\_\_  
 Date Recovered \_\_\_\_\_

T 27 S, R 4 W , Sec 21

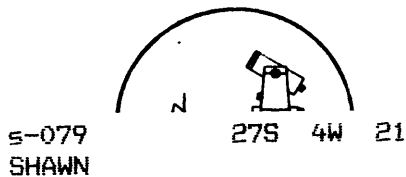

NAD 572496.77 4208309.74  
 83 43°12'23" 123°10'29"

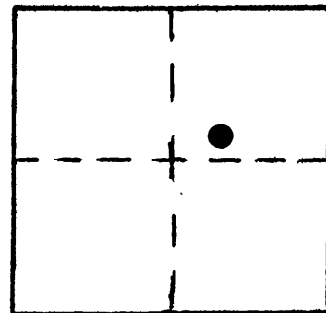

VERTICAL CONTROL NGVD 29

Elevation: 817.1 NGS Line # \_\_\_\_\_ USGS Line # \_\_\_\_\_ OSHD Line # \_\_\_\_\_  
 Precision: GPS Agency: DCSO Proj. # 2008 Date: 1992

HORIZONTAL CONTROL NAD 27

South Zone State Plane Coordinates: Y(Northing) 572,532.21 X(Easting) 1,287,351.40  
 Precision: 1/25,000 Agency: DCSO Proj. # 2004-19 CS#61/8 Date: 1980  
 Approximate Geographic Position: Latitude 43°12'23" Longitude 123°10'25"

DESCRIPTION and TO REACH

SKETCH

A DCSO disk stamped "SHAWN 1980" set in a 8" dia. concrete filled tile 4 in. below ground. A boat spike was driven into ground along side to aid in magnetic location.

TO REACH:

From the intersection of Co.Rd.#17 (Buckhorn Rd.) and Co.Rd.#136 (Strader Rd.) in T27S,R4W,Sec.20 proceed easterly along Co.Rd.#17 0.7 miles to monument on right.

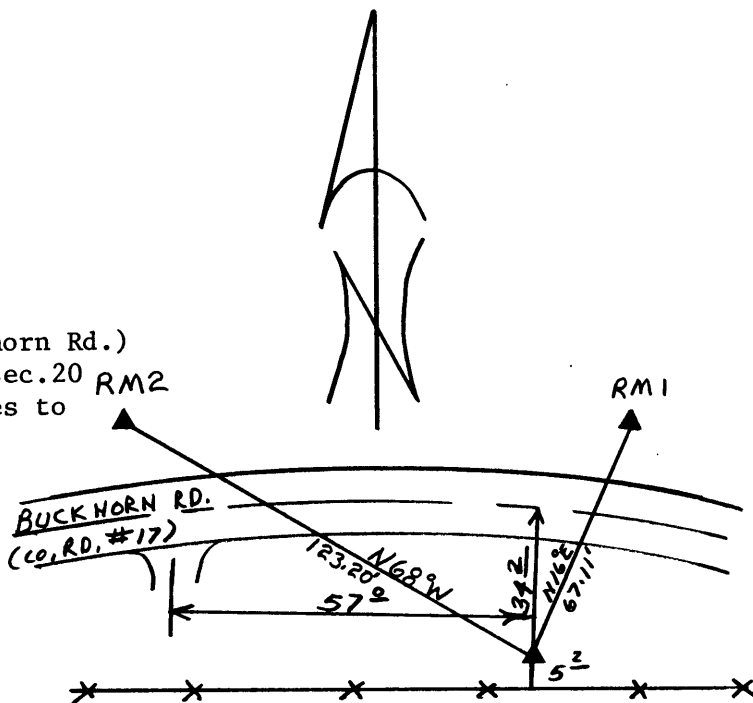

Reference Marks:

A DCSO disk stamped "SHAWN RM1 1980" bears N 18°43'16"E, 67.11 ft. (grid).  
 A DCSO disk stamped "SHAWN RM2 1980" bears N 65°42'32" W, 123.20 ft. (grid).

Note: For further information, contact the Douglas County Surveyor's Office, Room 205 Douglas County Justice Building, Roseburg, OR 97470. Phone 440-4278. Douglas County residents outside the Roseburg calling area, dial toll free 1-800-452-0991.