

OFFICE OF THE
DOUGLAS COUNTY SURVEYOR

s-061 225 12W 23
SC-12
NAD 742436.25 3969487.64
83 43°38'52" 124° 5'49"

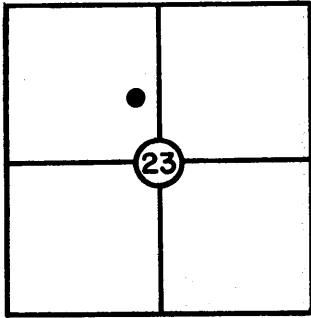

T 22 S, R 12W, Sec. 23

Station: SC-12

Set By (Agency): DCSO

Date: 1973

RECOVERED 3-23-82

VERTICAL CONTROL

NGVD 29
Elevation: 48.136 NGS(USC&GS) Line # _____ USGS Line # _____

Order
Of Precision 2nd Agency: DCSO Proj. #: 2006 Date: 1974

HORIZONTAL CONTROL

OCS 27
Oregon State Plane Coordinates: Y(Northing) 742,471.40 X(Easting) 1,048,526.82
(South Zone)

Order
Of Precision 1/25,000 Agency: DCSO Proj. #: 2006 Date: 1973

Approximate Geographic Position: Latitude = 43° 38' 52" Longitude = 124° 05' 45"

DESCRIPTION: Brass cap set in 6" belltile
approx. 6 ft. E. of edge of rd. and 15 ft.
N. of an 8 ft. culvert.

CAP STAMPED "SC-11 1973".

TO REACH FROM THE INTERSECTION OF SCHOFIELD
RIDGE RD. #5000 & CO. RD. #55 IN SEC. 14, T22S, R12W -
PROCEED SOUTHERLY 1.20 MILES ALONG RD. #55 TO
STATION ON RIGHT.

VICINITY: 4.45 mi. W'stly from Hwy. #38 and
Scholfield Cr. Rd. junction on Scholfield Cr. Rd.

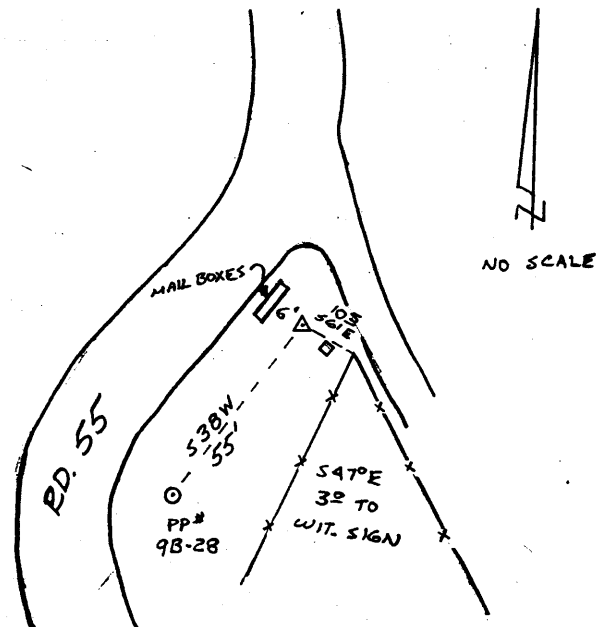

NOTE: For Possible Further Information On This Station, Please Contact The Douglas
County Surveyors Office, Rm. 205 Douglas County Justice Bldg., Roseburg, OR.
97470 Phone 672-3311 Ext. 272.. Douglas County residents outside the
Roseburg calling area dial toll free 1-800-452-0991.