

OFFICE OF THE

DOUGLAS COUNTY SURVEYOR

S-060
SC-11

22S 12W 23

NAD 744422.66 3969943.12
83 43°39'12" 124° 5'44"

T 22 S, R 12W, Sec. 23

Station: SC-11

Set By (Agency): DCSO

Date: 1973

RECOVERED 3/23/82

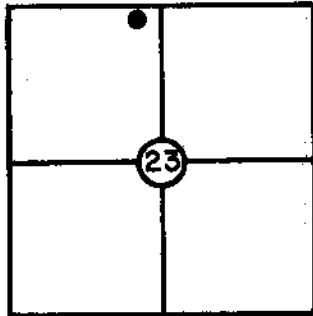

S-060

VERTICAL CONTROL

NGVD 29

Elevation: 35.520 NGS(USC&GS) Line # _____ USGS Line # _____

Order Of Precision 2nd Agency: DCSO Proj. #: 2006 Date: 1974

HORIZONTAL CONTROL

OCS 27

Oregon State Plane Coordinates: Y(Northing) 744,457.80 X(Easting) 1,048,982.31
(South Zone)

Order Of Precision 1/25,000 Agency: DCSO Proj. #: 2006 Date: 1973

Approximate Geographic Position: Latitude=43° 39' 12" Longitude=124° 05' 40"

DESCRIPTION: Brass cap set in 6" belltile
set approx. 30 ft. W. of Centerline of road
at N. edge of junction of Scholfield Crk. Rd.
and dirt rd.

CAP STAMPED "SC-11 1973".

FROM THE INTERSECTION OF SCHOLFIELD
RIDGE RD. #5000 & CO. RD. #55 IN SEC. 14
T22S R12W; PROCEED SOUTHERLY 0.80 MILES
ALONG CO. RD 55 TO STATION ON RIGHT.

VICINITY: 4.15 mi. W'stly of Hwy. #38 and

Scholfield Crk. Rd. Junct. on Scholfield Crk. Rd.

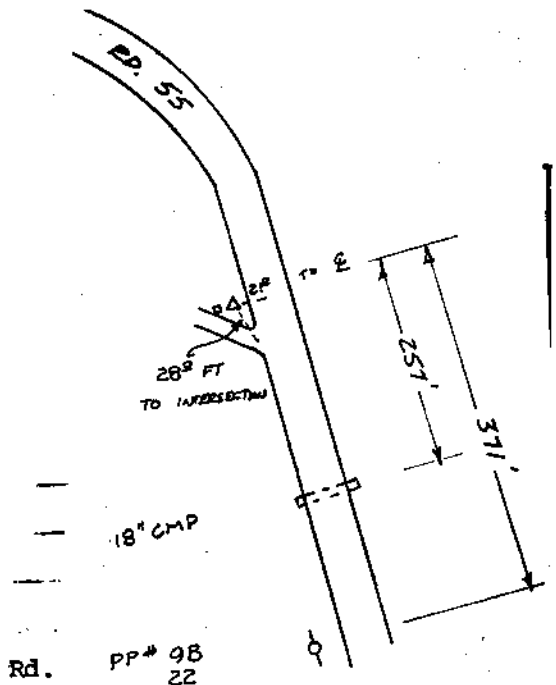

NOTE: For Possible Further Information On This Station, Please Contact The Douglas County Surveyors Office, Rm. 205 Douglas County Justice Bldg., Roseburg, OR. 97470 Phone 672-3311 Ext. 272. Douglas County residents outside the Roseburg calling area dial toll free 1-800-452-0991.