

OFFICE OF THE
DOUGLAS COUNTY SURVEYOR

Station: S-480

T 27 S, R 6 E, Sec 8 UNS

Set By (Agency): USC & GS

Date Set: 1941

Recovered By FLI (DCSO)

Date Recovered 6-15-84

Recovered By _____

Date Recovered _____

Recovered By _____

Date Recovered _____

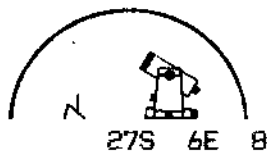
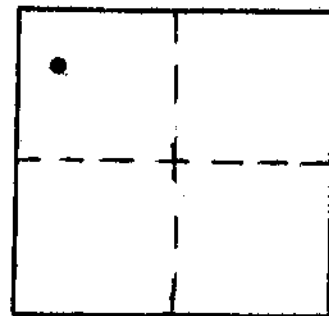

s-031
S 480

NAD 576462.28 4483165.64
83 43°14'12" 122° 8'39"

VERTICAL CONTROL NGVD 29

Elevation: 4814.400 NGS Line # 94 USGS Line # _____ OSHD Line # _____

Precision: 2nd Agency: DCSO Proj. # 2004-8 Date: 1974

HORIZONTAL CONTROL

South Zone State Plane Coordinates: Y(Northing) 576,499.87 X(Easting) 1,562,203.84

Precision: 1/25,000 Agency: DCSO Proj. # 2004-8 CS57/23 Date: 1975

Approximate Geographic Position: Latitude 43°14'12" Longitude 122°08'35"

DESCRIPTION and TO REACH

SKETCH

At junction of Hwy 138
and USFS Road #4793
(formerly 2711).

B.C. in concrete post
15 ft. west of Hwy 138.

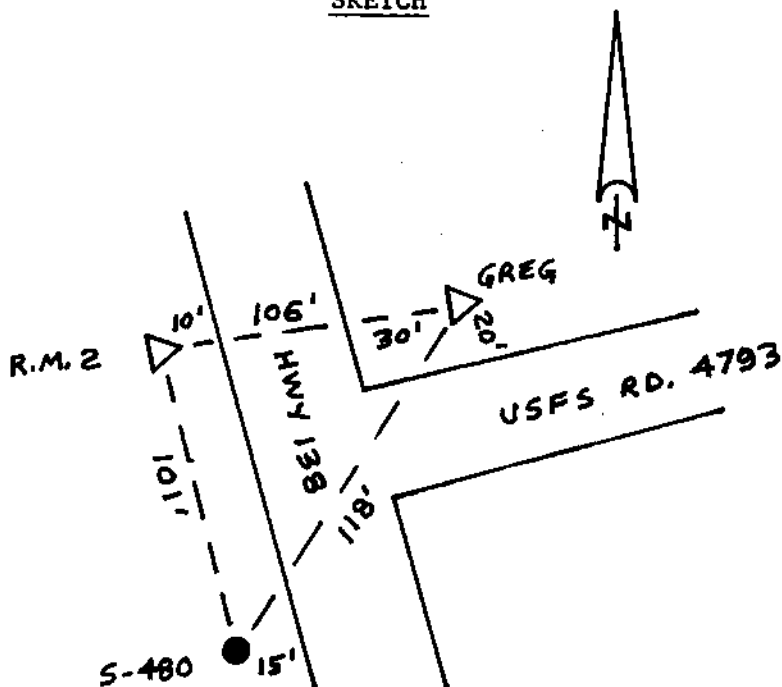

Reference Marks: Greg B.C. in 6" bell tile (El. 4821.186)
576,604.34 1,562,258.12

Greg R.M. 2 B.C. in 6" bell tile (El. 4813.815)
576,587.46 1,562,153.68

Note: For further information, contact the Douglas County Surveyor's Office, Room 205 Douglas County Justice Building, Roseburg, OR 97470. Phone 440-4278. Douglas County residents outside the Roseburg calling area, dial toll free 1-800-452-0991.