

OFFICE OF THE  
DOUGLAS COUNTY SURVEYOR

Station: S-19  
 Set By (Agency): DCSO  
 Date Set: 1973  
 Recovered By LEM  
 Date Recovered 1-82  
 Recovered By \_\_\_\_\_  
 Date Recovered \_\_\_\_\_  
 Recovered By \_\_\_\_\_  
 Date Recovered \_\_\_\_\_

T 20S S, R 10W , Sec 32



S-022  
S-19

20S 10W 32

NAD 791019.49 4020631.24  
 83 43°47'12" 123°54'41"

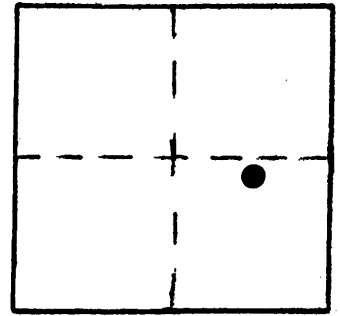

NGVD 29  
VERTICAL CONTROL

Elevation: 94.748 NGS Line # \_\_\_\_\_ USGS Line # \_\_\_\_\_ OSHD Line # \_\_\_\_\_  
 Precision: 2nd Agency: DCSO Proj. # 2006 Date: 1973

HORIZONTAL CONTROL NAD 27

South Zone State Plane Coordinates: Y(Northing) 791,055.12 X(Easting) 1,099,670.84  
 Precision: 1/25,000 Agency: DCSO Proj. # 2006 Date: 1973  
 Approximate Geographic Position: Latitude 43°47'13" Longitude 123°54'37"

DESCRIPTION and TO REACH

Found: A standard DCSO disk set flush with the ground in a boulder and stamped "S-19 1973". Monument is S 40° W of centerline of Smith River Rd. 33.0 ft. Witness post and sign bear S40 W 3.5 ft.

To reach: From the intersection of Co. Rd. #48A (North Fork Smith River) and Smith River Rd. in T20S R10W sec. 31. Proceed easterly along Smith River Rd. 1.4 miles to station on the right.

SKETCH

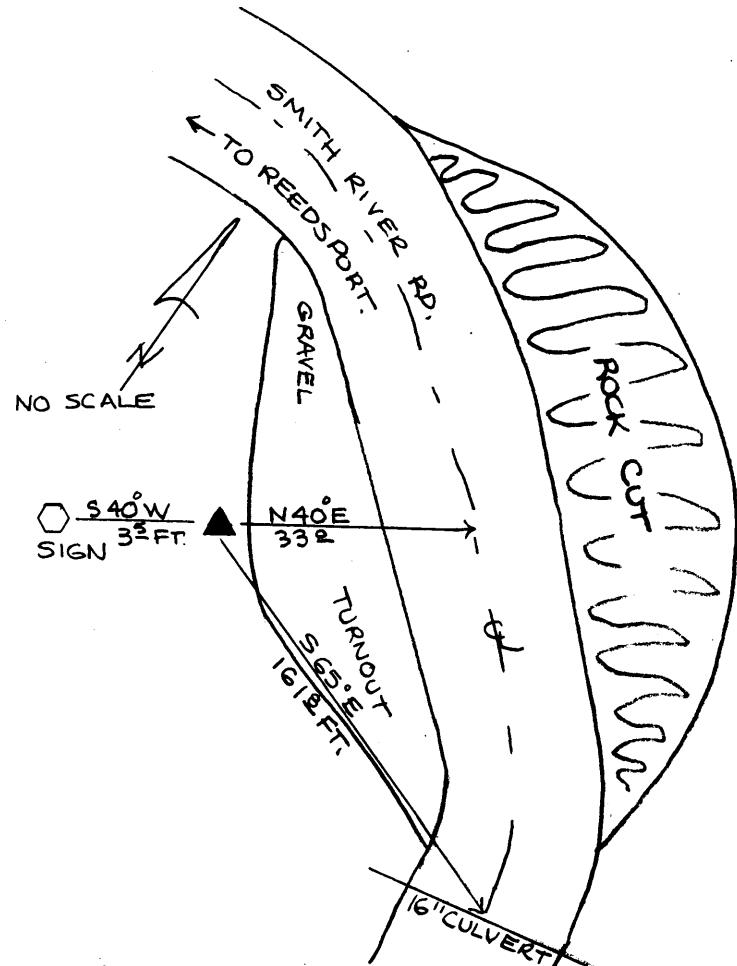

Reference Marks:

Note: For further information, contact the Douglas County Surveyor's Office, Room 205 Douglas County Justice Building, Roseburg, OR 97470. Phone 440-4278. Douglas County residents outside the Roseburg calling area, dial toll free 1-800-452-0991.