

OFFICE OF THE
DOUGLAS COUNTY SURVEYOR

Station: S-13 T 20 S, R 10W , Sec 31

Set By (Agency): DCSO

Date Set: 1973

Recovered By G.Q.-T.P.

Date Recovered 1-27-82

Recovered By _____

Date Recovered _____

Recovered By _____

Date Recovered _____

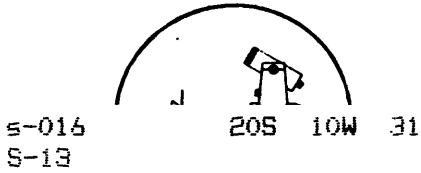
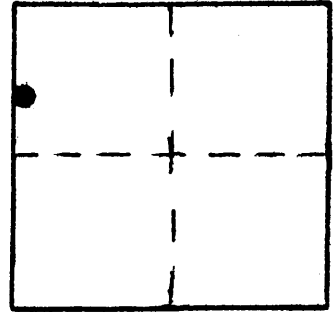

NAD 793796.41 4011074.76
83 43°47'36" 123°56'53"

**NGVD 29
VERTICAL CONTROL**

Elevation: 21.234 NGS Line # _____ USGS Line # _____ OSHD Line # _____

Precision: 2nd Agency: DCSO Proj. # 2006 Date: 1973

HORIZONTAL CONTROL NAD 27

South Zone State Plane Coordinates: Y(Northing) 793,831.98 X(Easting) 1,090,114.54

Precision: 1/25,000 Agency: DCSO Proj. # 2006 Date: 1973

Approximate Geographic Position: Latitude 43°47'36" Longitude 123°56'49"

DESCRIPTION and TO REACH

SKETCH

Found a standard DCSO disk set in concrete tile stamped "S-13 1973". Survey marker sign 2 ft. south.

To reach: From intersection of Co. Rd. #48A & Co. Rd. #48 (in sec. 31 T20S R10W) Proceed along Rd.#48 southwesterly 1.7mi. to station on the left.

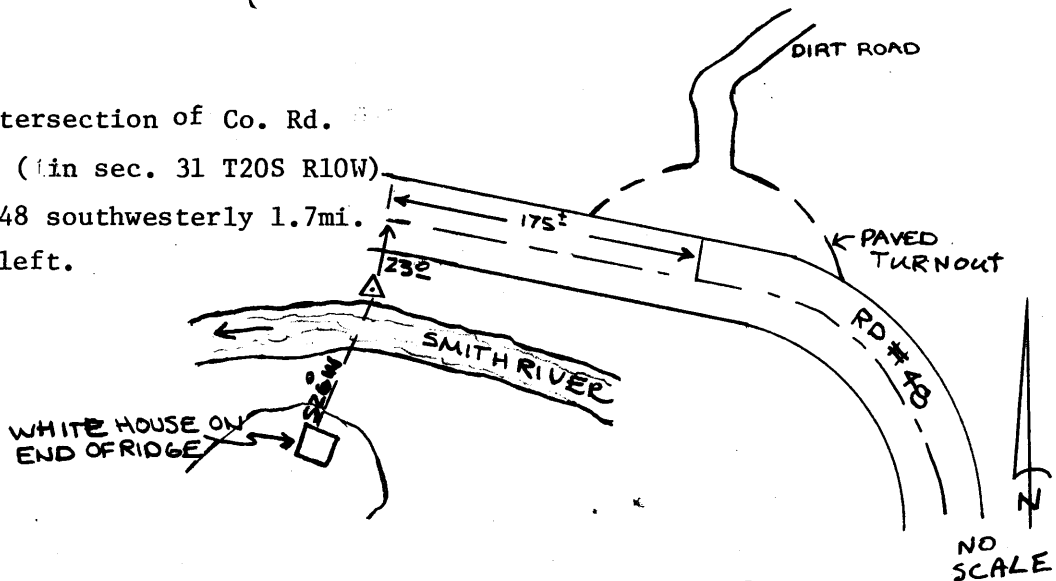

Reference Marks:

Note: For further information, contact the Douglas County Surveyor's Office, Room 205 Douglas County Justice Building, Roseburg, OR 97470. Phone 440-4278. Douglas County residents outside the Roseburg calling area, dial toll free 1-800-452-0991.