

OFFICE OF THE
DOUGLAS COUNTY SURVEYOR

Station: S-11
 Set By (Agency): DCSO
 Date Set: 1973
 Recovered By G.Q.-T.P.
 Date Recovered 1-27-82
 Recovered By _____
 Date Recovered _____
 Recovered By _____
 Date Recovered _____

T 21 S, R 11W, Sec 2



S-014 21S 11W 2
 S-11

NAD 786909.70 4003714.49
 83 43°46'25" 123°58'29"

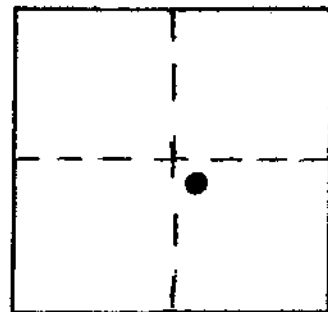

VERTICAL CONTROL

Elevation: 23.418 NGS Line # _____ USGS Line # _____ OSHD Line # _____
 Precision: 2nd Agency: DCSO Proj. # 2006 Date: 1973

HORIZONTAL CONTROL

South Zone State Plane Coordinates: Y(Northing) 786,945.19 X(Easting) 1,082,754.15
 Precision: 1/20,000 Agency: DCSO Proj. # 2006 Date: 1973
 Approximate Geographic Position: Latitude 43°46'25" Longitude 123°58'25"

DESCRIPTION and TO REACH

SKETCH

Found standard DCSO disk set in concrete tile buried 4" in the ground stamped "S-11 1973".
 Survey marker 2 ft. NE of the monument.

To reach: From the intersection of Co. Rd. #48A & 48 (in sec. 31 T20S R10W) Proceed southwesterly along Rd. #48 3.75 miles to monument on the left.

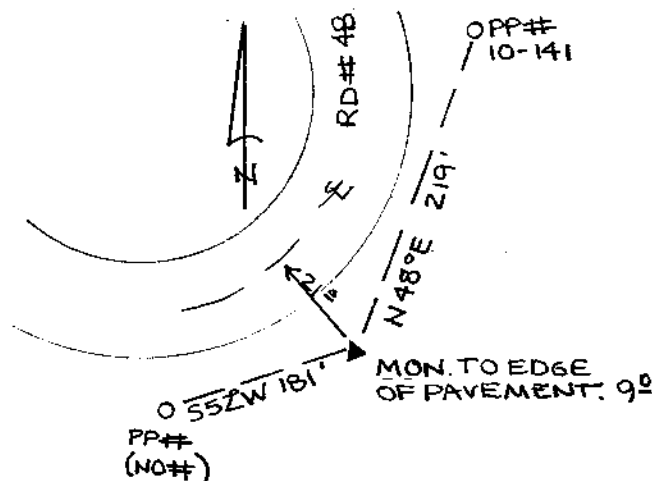

Reference Marks:

Note: For further information, contact the Douglas County Surveyor's Office, Room 205 Douglas County Justice Building, Roseburg, OR 97470. Phone 440-4278. Douglas County residents outside the Roseburg calling area, dial toll free 1-800-452-0991.