

OFFICE OF THE
DOUGLAS COUNTY SURVEYOR

Station: S-9 T 20 S, R 11W, Sec 35

Set By (Agency): DCSO

Date Set: 1973

Recovered By DCSO

Date Recovered GQ - TP

Recovered By 1-27-82

Date Recovered _____

Recovered By _____

Date Recovered _____

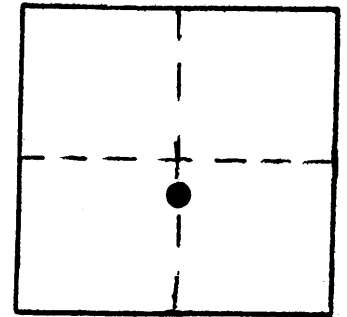

s-010
S-9 20S 11W 35

NAD 792125.82 4003739.90
83 43°47'16" 123°58'32"

VERTICAL CONTROL NGVD 29

Elevation: 36.138 NGS Line # _____ USGS Line # _____ OSHD Line # _____

Precision: 2nd Agency: DCSO Proj. # 2006 Date: 1973

HORIZONTAL CONTROL NAD 27

South Zone State Plane Coordinates: Y(Northing) 792,161.32 X(Easting) 1,082,779.63

Precision: 1/25,000 Agency: DCSO Proj. # 2006 Date: 1973

Approximate Geographic Position: Latitude 43°47'17" Longitude 123°58'28"

DESCRIPTION and TO REACH

SKETCH

Found: A standard DCSO disk set in concrete tile stamped "S-9 1973". Survey marker sign 3 ft. West of the monument.

NOTE: The road and shoulder in the area of the monument has settled since recent high water and appears to be in danger of sliding into the river.

To reach: From the intersection of Co. Rd. #48A & Rd. #48 (in sec 31 T20S R10W) proceed southwesterly along Rd. #48 5.35 miles to monument on the left.

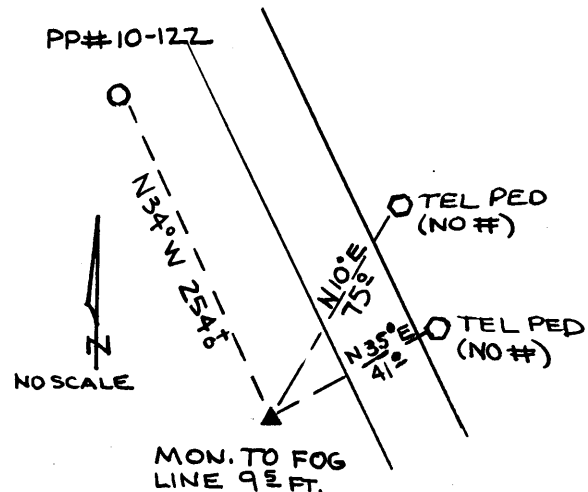

Reference Marks:

Note: For further information, contact the Douglas County Surveyor's Office, Room 205 Douglas County Justice Building, Roseburg, OR 97470. Phone 440-4278. Douglas County residents outside the Roseburg calling area, dial toll free 1-800-452-0991.