

OFFICE OF THE
DOUGLAS COUNTY SURVEYOR

Station: S-7 T 20 S, R 11W , Sec 34

Set By (Agency): DCSO

Date Set: 1973

Recovered By GQ -TP

Date Recovered 1-25-82

Recovered By _____

Date Recovered _____

Recovered By _____

Date Recovered _____

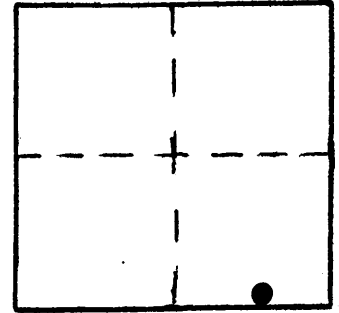

S-008 205 11W 34
S-7

NAD 790517.91 3999812.11
83 43°46'59" 123°59'25"

VERTICAL CONTROL NVD 29

Elevation: 13.13 NGS Line # _____ USGS Line # _____ OSHD Line # _____

Precision: 3rd Agency: DCSO Proj. # 2006 Date: 1989

HORIZONTAL CONTROL NAD 27

South Zone State Plane Coordinates: Y(Northing) 790,553.37 X(Easting) 1,078,851.79

Precision: 1/25,000 Agency: DCSO Proj. # 2006 Date: 1973

Approximate Geographic Position: Latitude 43°46'59" Longitude 123°59'20"

DESCRIPTION and TO REACH

Found: A standard DCSO disk set in concrete tile buried 6" under the ground stamped "S-7 1973". Disk is 2.6 ft. West of survey marker sign.

To reach: From the intersection of Co. Rd. #195 & Co. Rd. #48 (in sec 19 T21S R11W), proceed northeasterly 5.5 miles along Rd. #48 to USFS boating site and monument on the right.

SKETCH

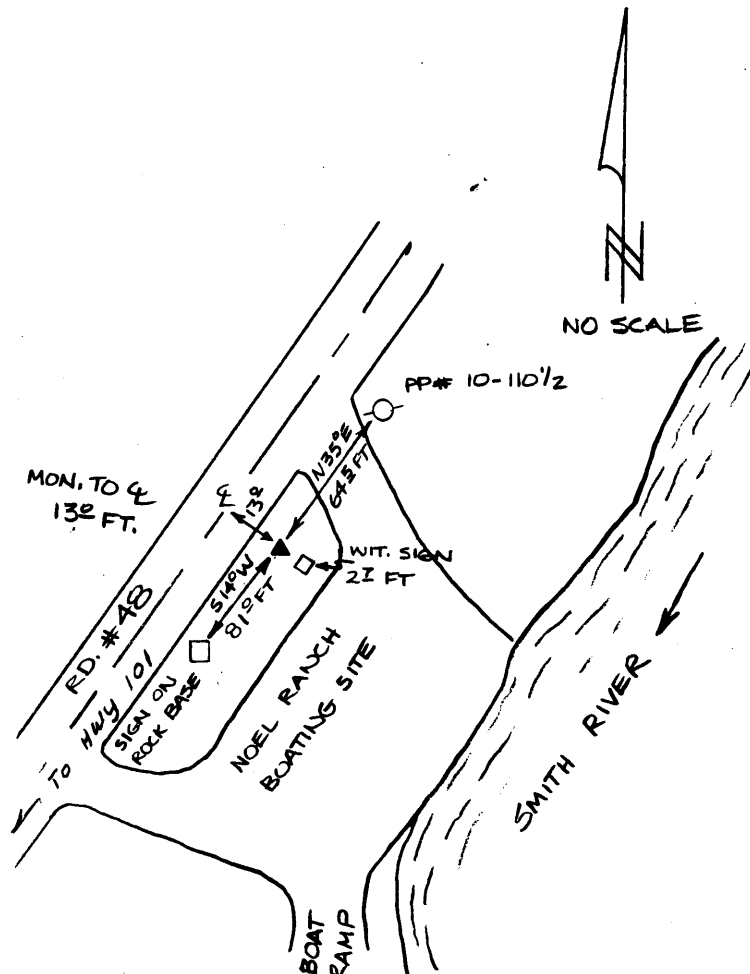

Reference Marks:

Note: For further information, contact the Douglas County Surveyor's Office, Room 205 Douglas County Justice Building, Roseburg, OR 97470. Phone 440-4278. Douglas County residents outside the Roseburg calling area, dial toll free 1-800-452-0991.