

DOUGLAS COUNTY SURVEYOR'S OFFICE

Designation: R-114 Station: RENN 2 T 27S R 6W S 11 ¼ NE

Date Set: 1990 Set by (Agency): A.A. SURVEYING

Date Recovered: 10/9/08 Recovered by: SJF

- Found New Reset
 Not Found Referenced Destroyed

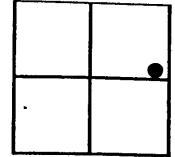

VERTICAL CONTROL

NGVD 29 Elevation: 464.87 Feet File # M111-11
 Precision: 3RD. ORDER Agency: LS. 2287 Project: M111-11 Date: 1990
 NAVD 88 Elevation: _____ Meters File # _____
 Precision: _____ Agency: _____ Project: _____ Date: _____

HORIZONTAL CONTROL - south zone

N _____	E _____	Datum/Adj.: _____	Precision: _____
Lat: _____	Long: _____	Agency: _____	File # _____ Date: _____
N _____	E _____	Datum/Adj.: _____	Precision: _____
Lat: _____	Long: _____	Agency: _____	File # _____ Date: _____
N _____	E _____	Datum/Adj.: _____	Precision: _____
Lat: _____	Long: _____	Agency: _____	File # _____ Date: _____
N _____	E _____	Datum/Adj.: _____	Precision: _____
Lat: _____	Long: _____	Agency: _____	File # _____ Date: _____

DESCRIPTION AND TO REACH

A 1 7/8 INCH DIAM. BRASS CAP
STAMPED "AA SURVEYING INC."
SET IN CONCRETE, BELOW ASPHALT
ROAD SURFACE, UNDER AN 11 1/2
INCH DIAM. CAST IRON MONU-
MENT COLLAR AND COVER.

GO TO THE INTERSECTION OF
STEWART PARKWAY AND NW
RENN ST. IN THE NORTH-
EAST QUARTER OF T27S, R6W,
SECTION 11. PROCEED
SOUTHEASTERLY ALONG NW
RENN ST. APPROX. 0.15 MI.
TO MON. AT CENTER OF ROADWAY.

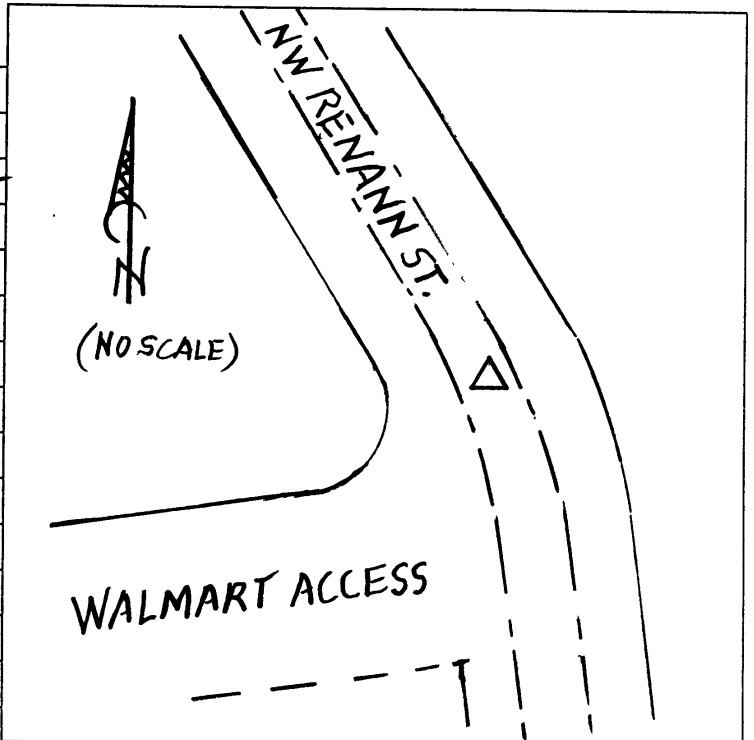

PHOTO FILE NAME

LOCATION

100-1346 (NE 100 1000 20 R-114
7/28/09)

M101315A

PROCESSED BY: _____

DATE: _____



10.13.2008