

# Douglas County Geodetic Data Sheet

Station: RC-5

Designation: R-101

T 29 R 06 WS 17 C

Date Set: 1998 Set By (Agency): DCSO

Last Date Recovered: 12/00/2000

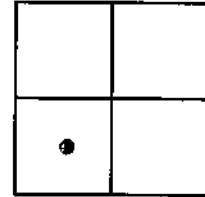

## VERTICAL CONTROL

NGVD 29 Elevation: 732.16 Feet

Precision: 3RD ORDER Agency: DCSO

CS File: 66055

Date: 1998

NAVD 88 Elevation: Meters

Precision: Agency:

CS File:

Date:

## HORIZONTAL CONTROL

OCS 27 Y(Northing): X(Easting): Lat 43° 02' 47.5" Long: 123° 26' 13.5"

Precision: GIS Agency: CS File: Date:

OCS 83 Y(Northing): X(Easting): Lat Long:

Precision: Agency: CS File: Date:

OCS 83/91 Y(Northing): X(Easting): Lat Long:

Precision: Agency: CS File: Date:

OCS 83/98 Y(Northing): X(Easting): Lat Long:

Precision: Agency: CS File: Date:

Description: Scaled Lat 43° 02' 48" Long: 123° 26' 13"

A DCSO BRASS CAP STAMPED; RC-5 1998; SET IN AN 8 X 42 INCH CONCRETE FILLED BELL TILE; PROTRUDES 6 IN. ABOVE GROUND.

## Comments:

FROM THE INTERSECTION OF WILLIS CREEK RD;  
CO. RD 43; AND RICE CREEK ROAD; CO. RD  
43A; IN T29S R6W SEC. 4; PROCEED  
SOUTHERLY ALONG RICE CREEK RD APPROX.  
3.00 MILES TO MONUMENT OF LEFT.

## Notes:

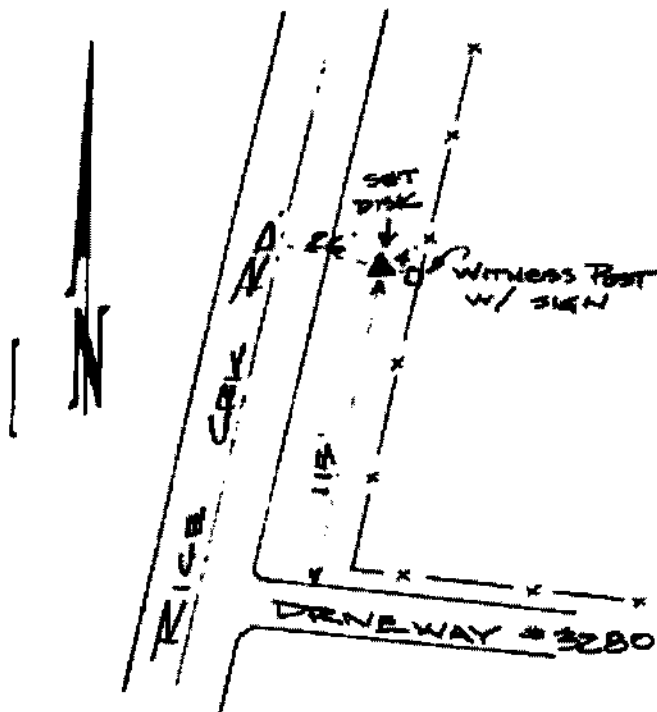

Note: For further information contact the Douglas County Surveyors Office, Room 105A Douglas County Courthouse, Roseburg, OR 97470. Phone 440-4272 or Fax (541)957-8150. Douglas County Residents outside Roseburg calling area, dial toll free 1-800-224-1619.