

OFFICE OF THE
DOUGLAS COUNTY SURVEYOR

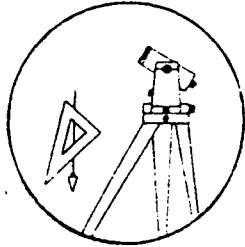

DESIG. R-085

Station: RUSH
Date Set: 1991
Set By (Agency): DCSO
Date Recovered: 3/8/91
Recovered By: SJF - TF
Date Recovered: _____
Recovered By: _____
Date Recovered: _____
Recovered By: _____

T 28 S, R 4W , Sec 33

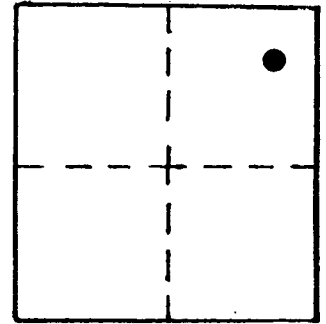

VERTICAL CONTROL

Elevation: 914.316 NGS Line # _____ USGS Line # _____ OSHD Line # _____
Precision: 2nd Agency: DCSO Proj. # 2007 Date: 1991

HORIZONTAL CONTROL CORPSCON6 NAVD88 917.788 FT. CS 66/43

South Zone O.C.S. 27: Y(Northing) _____ X(Easting) _____

South Zone O.C.S. 83: Y(Northing) 532160 X(Easting) 4207888

Precision: GIS SCALED Agency: DCSO Proj. # _____ Date: 2014

Approx. NAD ~~83~~ 27 Geographic Position: Latitude 43°05'42" Longitude 123°10'12"

DESCRIPTION and TO REACH

A standard DCSO disk stamped "RUSH 1991" set in a 8" x 40" concrete filled belltile protruding 2" above ground.

To reach:

From the intersection of North Myrtle Rd. (Co. Rd #15) and Slide Creek Rd. (Co. Rd. #149) in T28S, R4W, sec. 33 proceed northerly along North Myrtle Rd. 0.50 mi. to mon on the left.

SKETCH

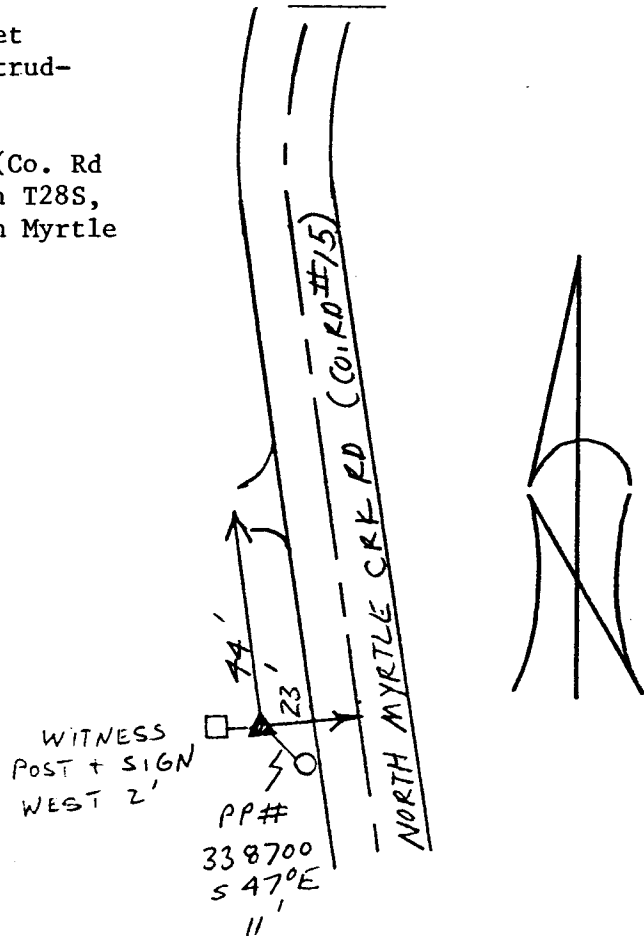

Reference Marks:

Note: For further information, contact the Douglas County Surveyor's Office, Room 205 Douglas County Justice Building, Roseburg, OR 97470. Phone 440-4278. Douglas County residents outside the Roseburg calling area, dial toll free 1-800-452-0991.