

OFFICE OF THE
DOUGLAS COUNTY SURVEYOR

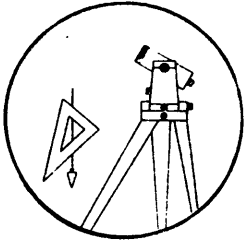

R-077

Station: Rashell T 27 S, R 7 W, Sec 1
Set By (Agency): DCSO
Date Set: 1989
Recovered By RWS, SJF
Date Recovered 5/30/89
Recovered By _____
Date Recovered _____
Recovered By _____
Date Recovered _____

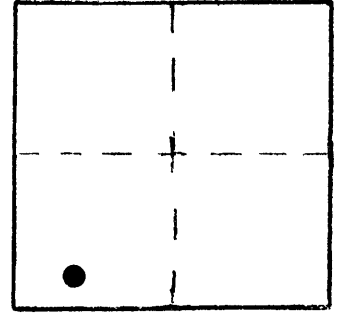

VERTICAL CONTROL **NGVD 29**

Elevation: 491.442 NGS Line # _____ USGS Line # _____ OSHD Line # _____
Precision: 2nd Agency: DCSO Proj. # 2007 Date: 1990

HORIZONTAL CONTROL

South Zone State Plane Coordinates: Y(Northing) _____ X(Easting) _____
Precision: _____ Agency: _____ Proj. # _____ Date: _____
Approximate Geographic Position: Latitude _____ Longitude _____

DESCRIPTION and TO REACH

A DCSO disk stamped "RASHELL 1989" set
at southwest corner of box culvert.

From the intersection of Melrose Rd. (Co.Rd.#51B)
and Doerner Rd.(Co.Rd.#90), in T27S,R7W,Sec.1,
proceed westerly 0.1 miles to small creek and
monument on left.

SKETCH

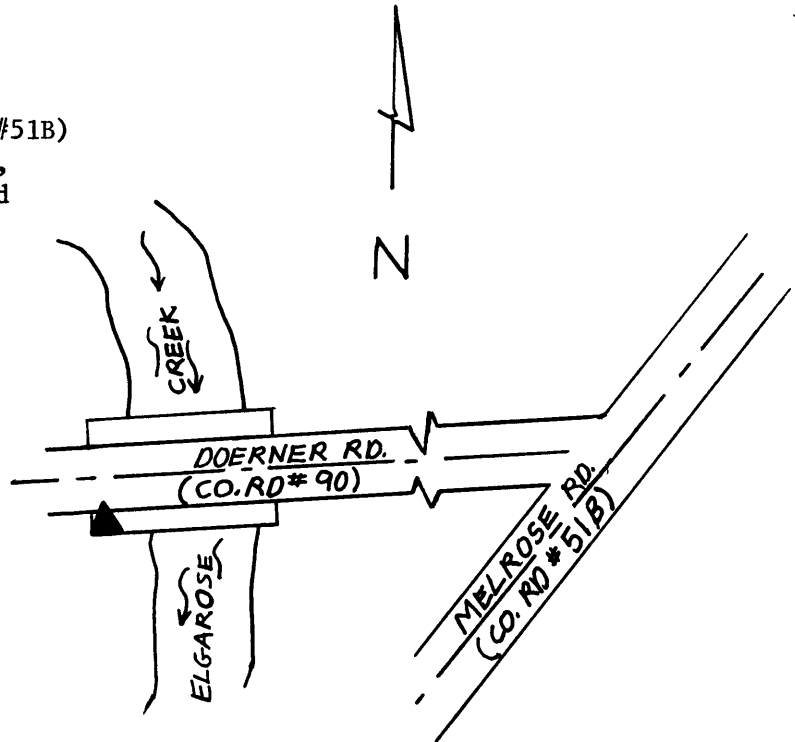

Reference Marks:

Note: For further information, contact the Douglas County Surveyor's Office, Room 205
Douglas County Justice Building, Roseburg, OR 97470. Phone 440-4278. Douglas
County residents outside the Roseburg calling area, dial toll free 1-800-452-0991.