

OFFICE OF THE
DOUGLAS COUNTY SURVEYOR

Station: _____ ROCK T 28 S, R 7 1/2 W, Sec 6

Set By (Agency): DCSO

Date Set: 1972

Recovered By RS, SJF

Date Recovered Sept. 10, 1984

Recovered By _____

Date Recovered _____

Recovered By _____

Date Recovered _____

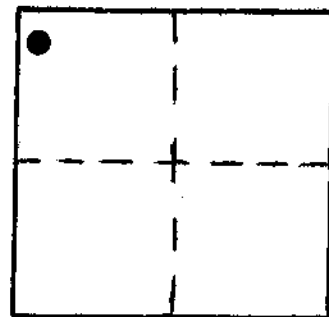

r-048
ROCK 28S 7 1/2W 6

NAD 562616.58 4099154.20
83 43°10' 8" 123°34'57"

VERTICAL CONTROL NGVD 29

Elevation: 1032 ft. NGS Line # _____ USGS Line # _____ OSHD Line # _____

Precision: VA Agency: DCSO Proj. # 2004 C.S.56/8 Date: 1972

HORIZONTAL CONTROL OCS 27

South Zone State Plane Coordinates: Y(Northing) 562,651.04 X(Easting) 1,178,195.40

Precision: 1/25,000 Agency: DCSO Proj. # 2004 C.S. 56/8 Date: 1972

Approximate Geographic Position: Latitude 43°10'09" Longitude 123°34'53"

DESCRIPTION and TO REACH

A DCSO disk (drill cap) stamped "ROCK 1972" set flush on surface of large sandstone rock, 10x2 1/2x1 1/2 feet tall.

TO REACH:

From the intersection of Flounoy Valley Road (Co. Rd.#51) and Reston Road (Co.Rd.#5) IN T27S,R7W,Sec.32 proceed southwesterly along Reston Road approximately 1.7 miles to a private road on the right. Proceed northwesterly along private road approximately 0.15 miles to mobile home site. Proceed past mobile home site along BPA access road approximately 0.1 miles to monument on left. Monument is within cleared powerline easement and under high-tension lines carried on wooden poles.

SKETCH

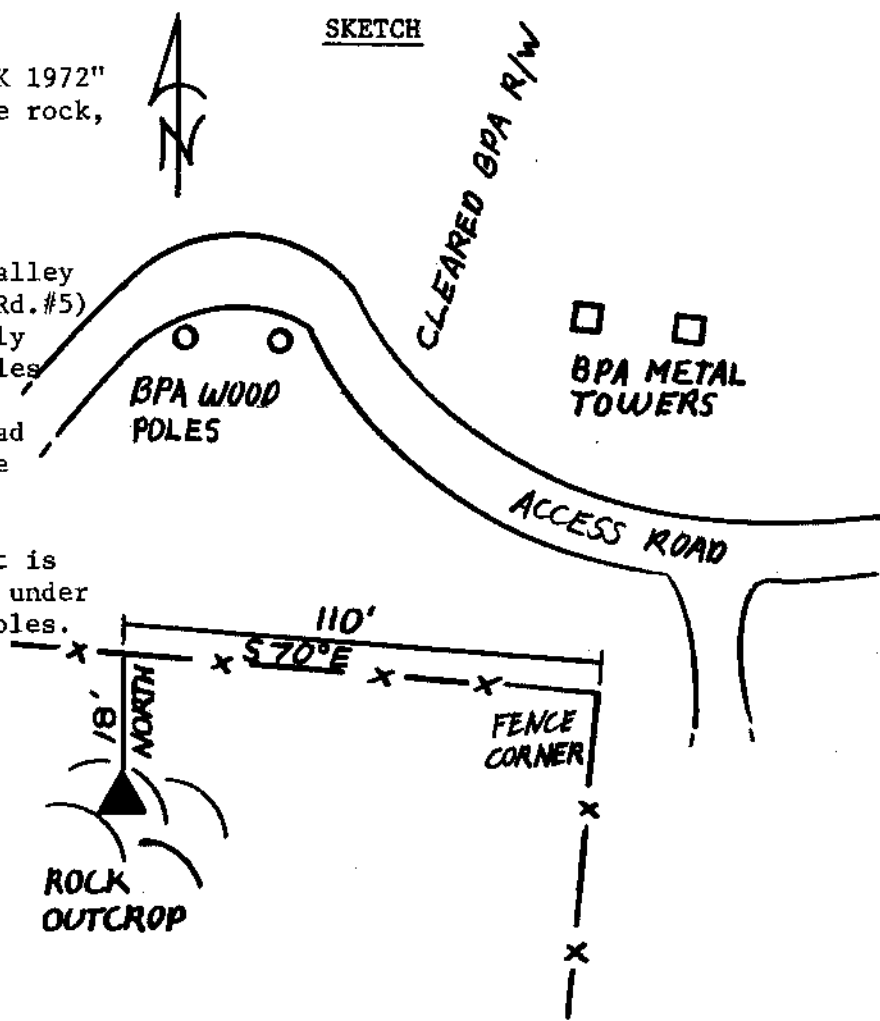

Reference Marks:

Note: For further information, contact the Douglas County Surveyor's Office, Room 205 Douglas County Justice Building, Roseburg, OR 97470. Phone 440-4278. Douglas County residents outside the Roseburg calling area, dial toll free 1-800-452-0991.