

OFFICE OF THE
DOUGLAS COUNTY SURVEYOR

Station: RESTON
 Set By (Agency): DCSO
 Date Set: 1972
 Recovered By RS,SF
 Date Recovered 8/14/84
 Recovered By _____
 Date Recovered _____
 Recovered By _____
 Date Recovered _____

T 28 S, R 8 W , Sec 14

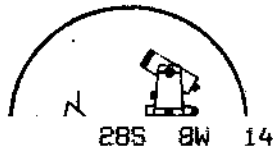

r-033
RESTON

NAD 551885.36 4088144.61
 83 43° 8'18" 123°37'20"

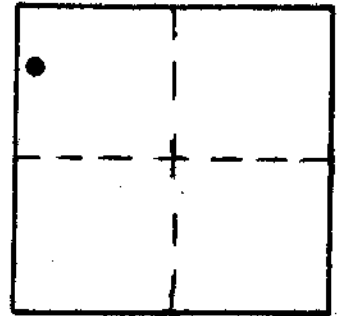

VERTICAL CONTROL

Elevation: _____ NGS Line # _____ USGS Line # _____ OSHD Line # _____
 Precision: _____ Agency: _____ Proj. # _____ Date: _____

HORIZONTAL CONTROL OCS 27

South Zone State Plane Coordinates: Y(Northing) 551,919.76 X(Easting) 1,167,205.89
 Precision: 1/25,000 Agency: DCSO Proj. # 2004 CS56/8 Date: 1972
 Approximate Geographic Position: Latitude 43°08'19" Longitude 123°37'15"

DESCRIPTION and TO REACH

SKETCH

Description:

A DCSO disk stamped "RESTON 1972" set in an 8 in. diameter concrete filled bell tile flush with ground.



TO REACH:

From the intersection of Reston Rd. (Co. Rd. #5) and Coos Bay Wagon Rd. (Co. Rd. #112) in T288, R8W, Sec.14, proceed westerly along Coos bay Wagon Rd. approx. 0.15 miles to monument on right. Monument lies 4 ft. north of top of cut bank approx. 7 ft. higher than road surface.

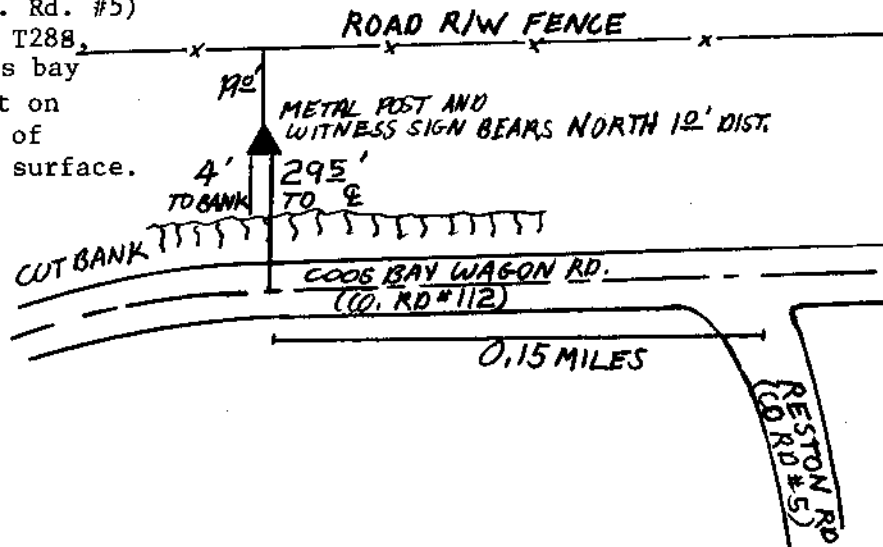

Reference Marks:

Note: For further information, contact the Douglas County Surveyor's Office, Room 205 Douglas County Justice Building, Roseburg, OR 97470. Phone 440-4278. Douglas County residents outside the Roseburg calling area, dial toll free 1-800-452-0991.