

OFFICE OF THE
DOUGLAS COUNTY SURVEYOR

Station: RANDALL T 28 S, R 6W , Sec 15
Set By (Agency): Don Garrett (LS#0544)

Date Set: 1972

Recovered By SIF

Date Recovered April 27, 1984

Recovered By _____

Date Recovered _____

Recovered By _____

Date Recovered _____

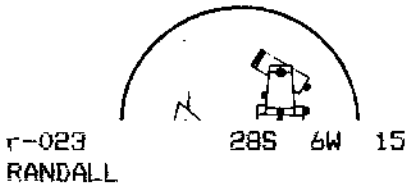
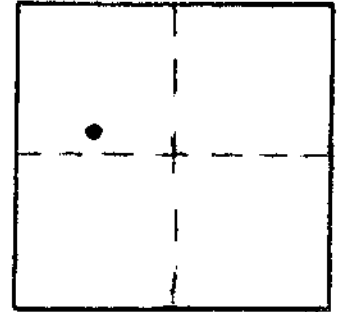

NAD 548903.78 4147555.25
83 43° 8'10" 123°23'58"

VERTICAL CONTROL **NGVD 29**

Elevation: 629.51 ft. NGS Line # _____ USGS Line # _____ OSHD Line # _____
Precision: 3rd. Agency: Don Bentz Proj. # _____ Date: 1972
L.S. #0839

HORIZONTAL CONTROL **OCS 27**

South Zone State Plane Coordinates: Y(Northing) 548,938.94 X(Easting) 1,226,596.93
Precision: 1/25,000 Agency: DCSO Proj. # 2005 C.S. 56/9 Date: 1972
Approximate Geographic Position: Latitude 43°08'10" Longitude 123°23'54"

DESCRIPTION and TO REACH

A DCSO disk stamped "RANDALL 1972" cemented flush near the summit of sandstone dome ridge.

To Reach:

From the intersection of State Highway 99 and Rolling Hills Drive in T28S,R6W,Sec.15 proceed northwesterly along Rolling Hills Drive approximately 0.1 miles to driveway of 110 Rolling Hills Drive on right, proceed southwesterly along driveway approximately 0.1 miles to a house. Monument lies approximately 200 ft. southwesterly of summit of prominent hill directly behind house.

SKETCH

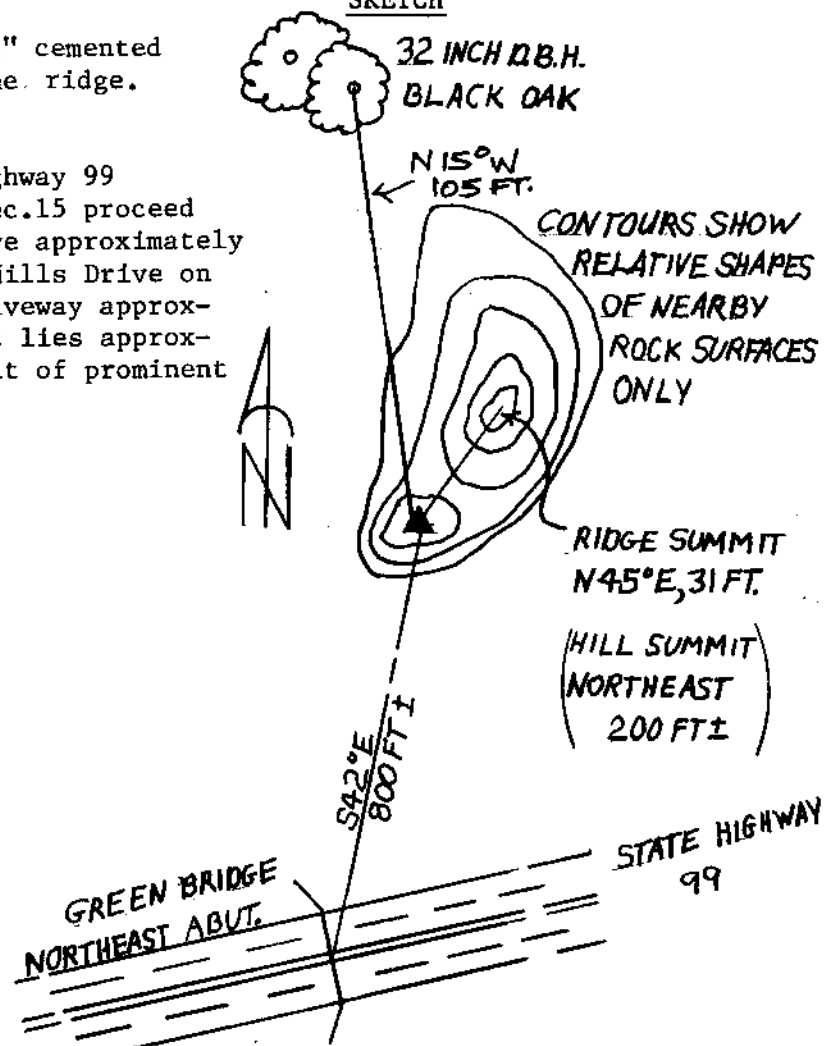

Reference Marks:

Note: For further information, contact the Douglas County Surveyor's Office, Room 205 Douglas County Justice Building, Roseburg, OR 97470. Phone 440-4278. Douglas County residents outside the Roseburg calling area, dial toll free 1-800-452-0991.