

OFFICE OF THE  
DOUGLAS COUNTY SURVEYOR

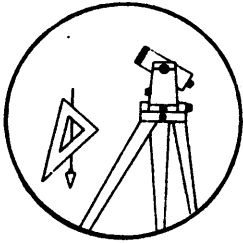

Station: R500 T 31 S, R 2 W, Sec 3  
 Set By (Agency): USC&GS  
 Date Set: 1949  
 Recovered By RS, SF  
 Date Recovered 1/18/84  
 Recovered By \_\_\_\_\_  
 Date Recovered \_\_\_\_\_  
 Recovered By \_\_\_\_\_  
 Date Recovered \_\_\_\_\_

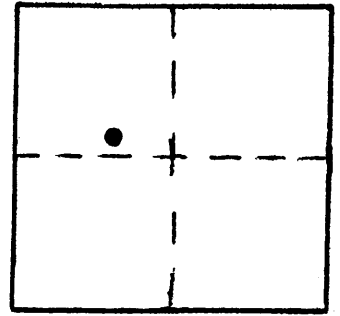

R-010

VERTICAL CONTROL NGVD 29

Elevation: 1233.442 NGS Line # 130 USGS Line # \_\_\_\_\_ OSHD Line # \_\_\_\_\_  
 Precision: 2nd Agency: USC&GS Proj. # \_\_\_\_\_ Date: 1957

HORIZONTAL CONTROL

South Zone State Plane Coordinates: Y(Northing) \_\_\_\_\_ X(Easting) \_\_\_\_\_  
 Precision: \_\_\_\_\_ Agency: \_\_\_\_\_ Proj. # \_\_\_\_\_ Date: \_\_\_\_\_  
 Approximate Geographic Position: Latitude \_\_\_\_\_ Longitude \_\_\_\_\_

DESCRIPTION and TO REACH

SKETCH

DESCRIPTION:

A USC&GS disk stamped "R500 1949"  
set flush in a vertical rock wall.

TO REACH:

From the intersection of State Hwy. 227  
and Tiller-South Umpqua Rd. (Co.Rd.#46)  
in T30S,R2W,Sec.33, proceed southeasterly  
along State Hwy. 227, 1.85 miles to monument  
on left.

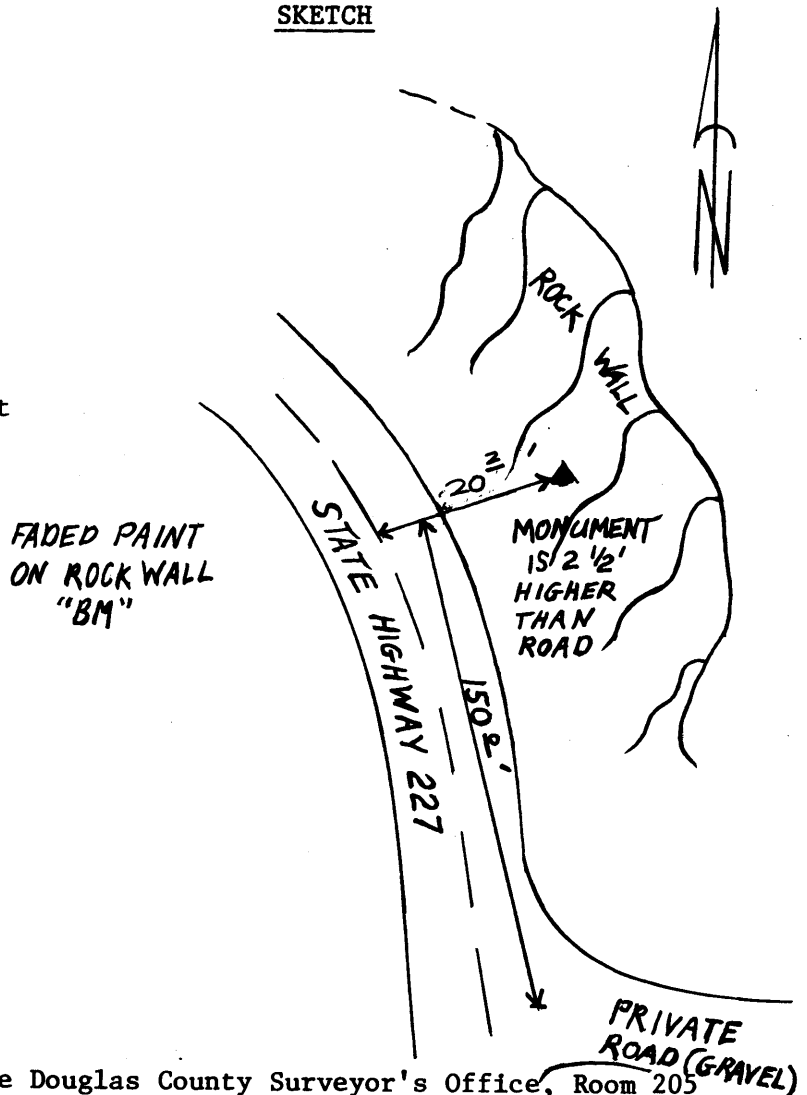

Reference Marks:

Note: For further information, contact the Douglas County Surveyor's Office, Room 205  
Douglas County Justice Building, Roseburg, OR 97470. Phone 440-4278. Douglas  
County residents outside the Roseburg calling area, dial toll free 1-800-452-0991.