

OFFICE OF THE  
DOUGLAS COUNTY SURVEYOR

Station: R-480 T 27 S, R 6 E., Sec 6 UNS

Set By (Agency): USC & GS

Date Set: 1941

Recovered By FLI (DCSO)

Date Recovered 6-15-84

Recovered By \_\_\_\_\_

Date Recovered \_\_\_\_\_

Recovered By \_\_\_\_\_

Date Recovered \_\_\_\_\_

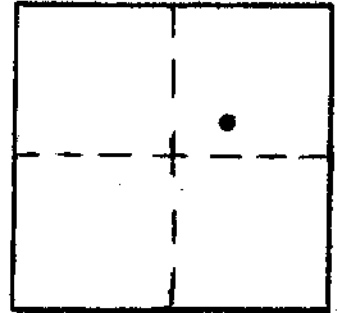

R-008

VERTICAL CONTROL NGVD 29

Elevation: 4635.551 NGS Line # 94 USGS Line # \_\_\_\_\_ OSHD Line # \_\_\_\_\_

Precision: 2nd Agency: DCSO Proj. # 2004-8 Date: 1974

HORIZONTAL CONTROL

South Zone State Plane Coordinates: Y(Northing) \_\_\_\_\_ X(Easting) \_\_\_\_\_

Precision: \_\_\_\_\_ Agency: \_\_\_\_\_ Proj. # \_\_\_\_\_ Date: \_\_\_\_\_

Approximate Geographic Position: Latitude \_\_\_\_\_ Longitude \_\_\_\_\_

DESCRIPTION and TO REACH

SKETCH

0.4 miles S.E. along old Highway 209 from junction of Hwy 138 and USFS Road Number 60 (formerly 2500).

Brass cap in concrete post 33 feet S.W. of road.

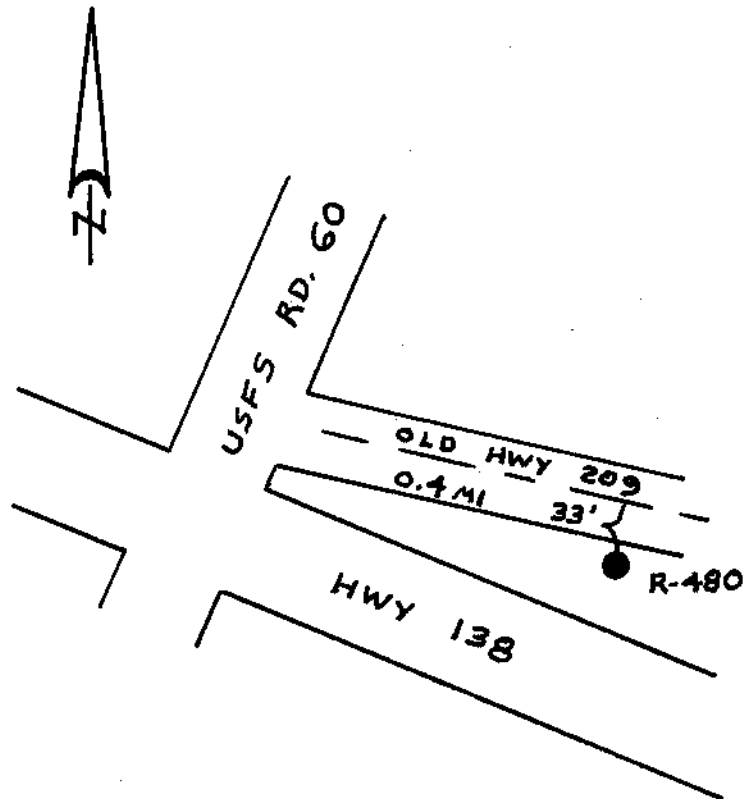

Reference Marks:

Note: For further information, contact the Douglas County Surveyor's Office, Room 205 Douglas County Justice Building, Roseburg, OR 97470. Phone 440-4278. Douglas County residents outside the Roseburg calling area, dial toll free 1-800-452-0991.