

OFFICE OF THE
DOUGLAS COUNTY SURVEYOR

Station: Q 353
 Date Set: 1942
 Set By (Agency): USC&GS
 DCSO Designation: Q-023
 Date Recovered: 8-93
 Recovered By: RWS SJF
 Date Recovered: _____
 Recovered By: _____
 Date Recovered: _____
 Recovered By: _____

T30W R5W Sec. 5

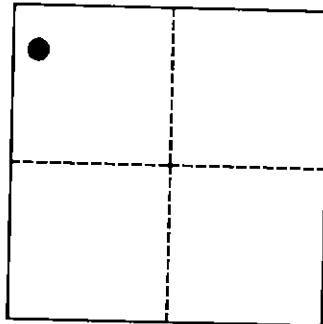
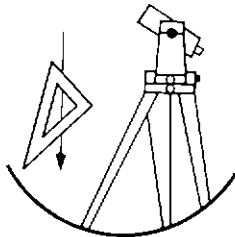

VERTICAL CONTROL

NGVD 29 Elevation: 618.844 FEET NAVD 88 Elevation: 189.668 METERS
 NGS Line # 125042 USGS LINE # _____ OSHD Line # _____ FILE # _____
 Precision: 1ST ORDER Agency: CGS Proj: _____ Date: 1988

HORIZONTAL CONTROL

O.C.S. 27 Y(Northing): _____ O.C.S. 83 Y(Northing): _____
 (South Zone) X(Easting): _____ (South Zone) X(Easting): _____
 Precision: _____ Agency: _____ Proj: _____ Date: _____
 Approx. O.C.S. 27 Geographic Position: Latitude: 42°59'50" Longitude: 123°19'19"
 Approx. O.C.S. 83 Geographic Position: Latitude: _____ Longitude: _____

Found: A 3 - 1/2 inch diameter USC&GS disk stamped "Q 353 1942" set flush in southwest end of southerly concrete headwall of a small culvert running under railroad tracks.

To reach: From the intersection of I-5 and Weaver Rd. (Co. Rd. #41) at I-5 exit 106 in T29S R5W Sec32 proceed southwesterly along Weaver Rd. approx. 1.10 miles to monument on left (550 feet southeasterly across fields and railroad tracks, see sketch for access.)

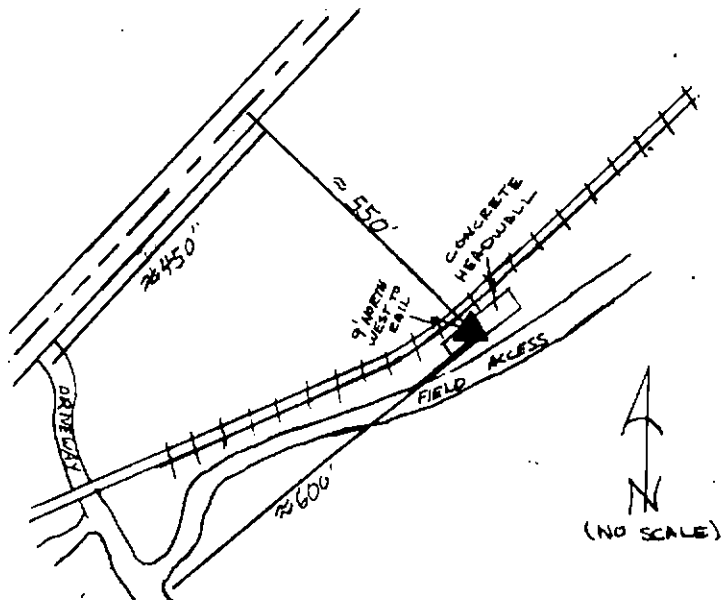

Note: For further information contact the Douglas County Surveyors Office, Room 205 Douglas County Justice Building, Roseburg, OR 97470. Phone 440-4272. Douglas County Residents outside Roseburg calling area, dial toll free 1-800-477-0991.