

**DOUGLAS COUNTY SURVEYOR'S OFFICE**

Designation: P-129 Station: PRUNE-2 T 30S R 5W S 07 ¼ SW

Date Set: APRIL, 2012 Set by (Agency): DCSO

Date Recovered: MAY, 2012 Recovered by: SJF, MSK

- Found
- New
- Reset
- Not Found
- Referenced
- Destroyed

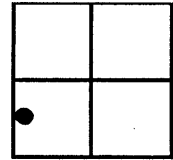

VERTICAL CONTROL

NGVD 29 Elevation: 647.45 Feet File # CS 67/37  
 Precision: 3RD ORDER Agency: DCSO Project: \_\_\_\_\_ Date: FEB, 2012  
 NAVD 88 Elevation: 198.39 Meters File # CS 67/37  
 Precision: 3RD ORDER Agency: DCSO Project: \_\_\_\_\_ Date: FEB, 2012

HORIZONTAL CONTROL - south-zone

N 489165.397 E 4159934.55 Datum/Adj.: NAD 83 Precision: 615  
 Lat: \_\_\_\_\_ Long: \_\_\_\_\_ Agency: \_\_\_\_\_ File # CS 67/37 Date: 2012  
 N \_\_\_\_\_ E \_\_\_\_\_ Datum/Adj.: \_\_\_\_\_ Precision: \_\_\_\_\_  
 Lat: \_\_\_\_\_ Long: \_\_\_\_\_ Agency: \_\_\_\_\_ File # \_\_\_\_\_ Date: \_\_\_\_\_  
 N \_\_\_\_\_ E \_\_\_\_\_ Datum/Adj.: \_\_\_\_\_ Precision: \_\_\_\_\_  
 Lat: \_\_\_\_\_ Long: \_\_\_\_\_ Agency: \_\_\_\_\_ File # \_\_\_\_\_ Date: \_\_\_\_\_  
 N \_\_\_\_\_ E \_\_\_\_\_ Datum/Adj.: \_\_\_\_\_ Precision: \_\_\_\_\_  
 Lat: \_\_\_\_\_ Long: \_\_\_\_\_ Agency: \_\_\_\_\_ File # \_\_\_\_\_ Date: \_\_\_\_\_

DESCRIPTION AND TO REACH

A 3 INCH DIAM. DCSO DRILL CAP  
STAMPED "PRUNE-2 2012" IS SET IN  
TOP OF CONCRETE FOOTING AT NORTH-  
EAST CORNER OF EAST ABUTMENT OF  
BRIDGE OVER SOUTH UMPQUA RIVER  
(BRIDGE BUILT 2009).

FROM THE INTERSECTION OF INTER-  
STATE HIGHWAY 5 AND PRUNER ROAD  
(Co. Rd. # 20) IN T30S, R5W, SECTION 7  
PROCEED WEST ALONG PRUNER  
ROAD APPROX. 0.45 MILES TO  
MONUMENT ON RIGHT.

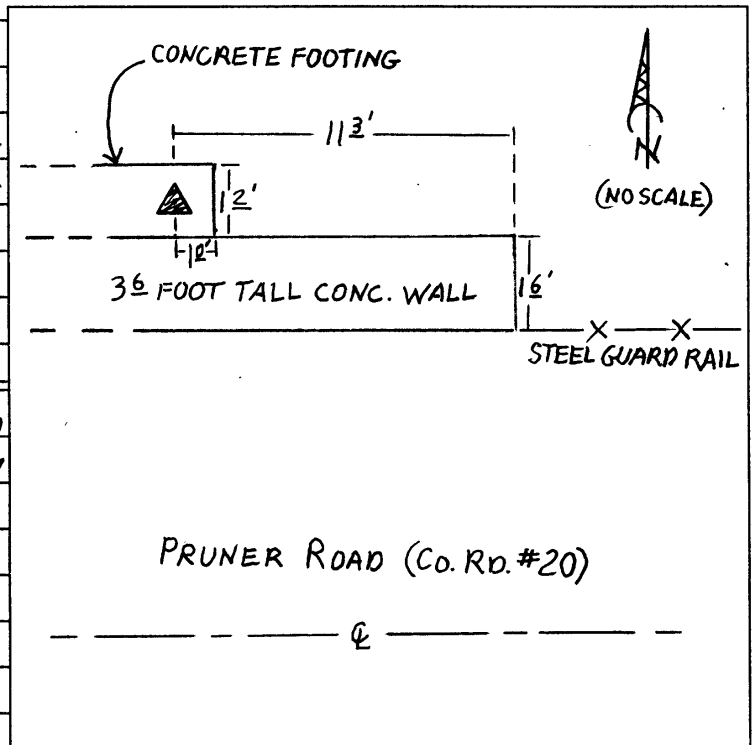

PHOTO FILE NAME

LOCATION

# 100-1713 (7/20/12 Renamed  
P-129)

M051714A

PROCESSED BY: \_\_\_\_\_

DATE: \_\_\_\_\_



5. 31. 1999