

DOUGLAS COUNTY SURVEYOR'S OFFICE

Designation: P-128 Station: PRUNE-1 T 30S R 6W S 12 ¼ SE

Date Set: APRIL, 2012 Set by (Agency): DCSO

Date Recovered: MAY, 2012 Recovered by: SJF, MSK

- Found
- New
- Reset
- Not Found
- Referenced
- Destroyed

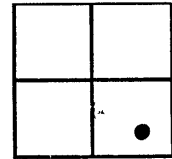

VERTICAL CONTROL

NGVD 29 Elevation: 651.06 Feet File # CS 67/37
 Precision: 3RD. ORDER Agency: DCSO Project: _____ Date: FEB, 2012
 NAVD 88 Elevation: 199.49 Meters File # CS 67/37
 Precision: 3RD. ORDER Agency: DCSO Project: _____ Date: FEB, 2012

HORIZONTAL CONTROL - south-zone

N 489140.233 E 4159315.723 Datum/Adj.: NAD 83 Precision: 615
 Lat: _____ Long: _____ Agency: _____ File # CS 67/37 Date: 2012
 N _____ E _____ Datum/Adj.: _____ Precision: _____
 Lat: _____ Long: _____ Agency: _____ File # _____ Date: _____
 N _____ E _____ Datum/Adj.: _____ Precision: _____
 Lat: _____ Long: _____ Agency: _____ File # _____ Date: _____
 N _____ E _____ Datum/Adj.: _____ Precision: _____
 Lat: _____ Long: _____ Agency: _____ File # _____ Date: _____

DESCRIPTION AND TO REACH

A 3 INCH DIAM. DCSO DRILL
CAP STAMPED "PRUNE-1 2012" IS
SET IN TOP OF CONCRETE FOOTING
AT SOUTH WEST CORNER OF WEST
ABUTMENT OF BRIDGE OVER SOUTH
UMPUA RIVER (BRIDGE BUILT 2009)

FROM THE INTERSECTION OF INTER-
STATE HIGHWAY 5 AND PRUNER ROAD
(CO. RD. #20) IN T30S, R5W, SECTION 7
PROCEED WEST ALONG PRUNER ROAD
APPROX. 0.60 MILES TO MONUMENT ON
LEFT.

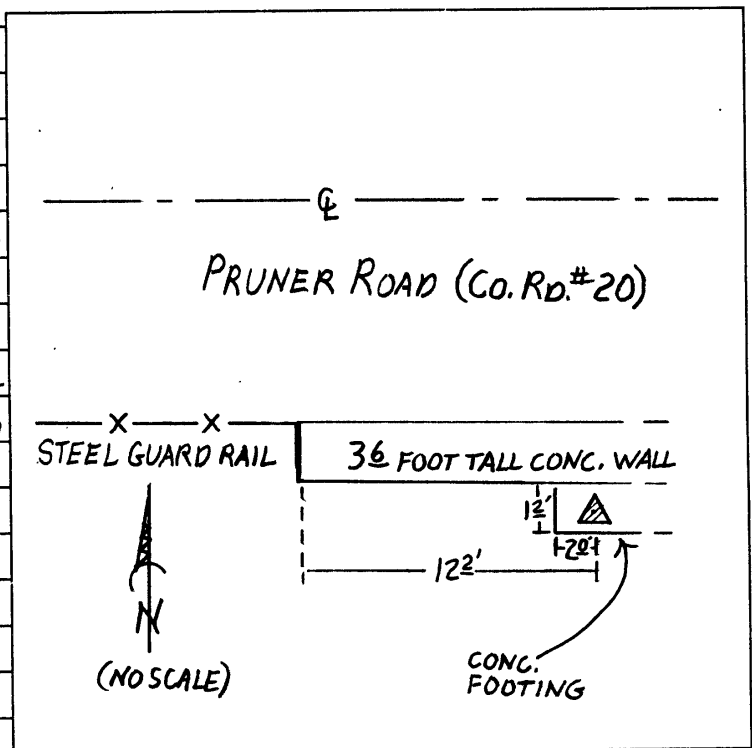

PHOTO FILE NAME

LOCATION

100-1412 (Renamed P-128)^{7/20/12}

M051714A

PROCESSED BY: _____

DATE: _____



5. 31. 1999