

DOUGLAS COUNTY SURVEYOR'S OFFICE

Designation: P-126 Station: PROPERTY CORNER PLS 1941 T 285 R 6 W S 22 1/4 SW

Date Set: N/A Set by (Agency): PRIVATE SURVEYOR

Date Recovered: AUG. 2005 Recovered by: S. FLAUSE ; J. PIKE

- Found New Reset
- Not Found Referenced Destroyed

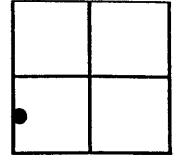

VERTICAL CONTROL

NGVD 29 Elevation: 560.20 Feet File # CS 67/17
 Precision: 3rd Agency: DCSO Project: _____ Date: 2005
 NAVD 88 Elevation: _____ Meters File # _____
 Precision: _____ Agency: _____ Project: _____ Date: _____

HORIZONTAL CONTROL - south zone

N 541834.3 E 414610.9 Datum/Adj.: NAD 83 Precision: G1S
 Lat: 43°06'59.5" Long: 123°24'14.1" Agency: DCSO File # CS.67/17 Date: 8/05
 N _____ E _____ Datum/Adj.: _____ Precision: _____
 Lat: _____ Long: _____ Agency: _____ File # _____ Date: _____
 N _____ E _____ Datum/Adj.: _____ Precision: _____
 Lat: _____ Long: _____ Agency: _____ File # _____ Date: _____
 N _____ E _____ Datum/Adj.: _____ Precision: _____
 Lat: _____ Long: _____ Agency: _____ File # _____ Date: _____

DESCRIPTION AND TO REACH

A 1 3/8" DIA BRASS DISC
STAMPED "PROPERTY CORNER
PLS 1941" SET FLUSH IN
CONCRETE GUTTER.

MONUMENT LIES AT THE
SW CORNER OF INTERSECTION
HALL ST. AND EDGEWOOD DR.
IN SW 1/4 SEC. 22, T.285 R6W.

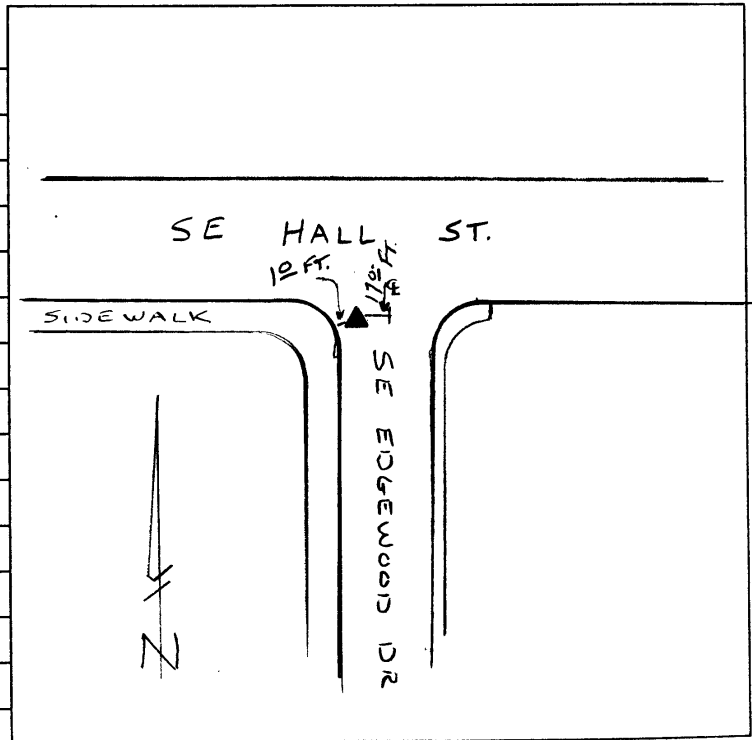

PHOTO FILE NAME

LOCATION

GPS FILE - M081716A

PICTURE FILE - # 100-1259

PROCESSED BY: _____

DATE: _____