

OFFICE OF THE
DOUGLAS COUNTY SURVEYOR

Station: Pond RM 2
 Date Set: 1983
 Set By (Agency): DCSO
 Date Recovered: 3-9-92
 Recovered By: SJF TF
 Date Recovered: RWS SJF 11/99
 Recovered By: _____
 Date Recovered: _____
 Recovered By: _____

T 26 S, R 3W , Sec 30

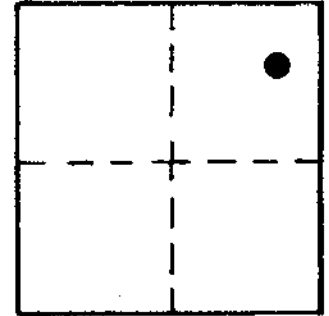

P-106 265 3W 30
POND RM 2

NAD 599986.44 4231221.76
83 43°17' 1" 123° 5'31"

VERTICAL CONTROL NGVD 29

Elevation: 721.7 NGS Line # _____ USGS Line # _____ OSHD Line # _____
 Precision: GPS Agency: DCSO Proj. # 2008 Date: 1992

CS 66/56

HORIZONTAL CONTROL

South Zone O.C.S. 27: Y(Northing) 600,022,09 X(Easting) 1,310,261,80
 South Zone O.C.S. 83: Y(Northing) _____ X(Easting) _____
 Precision: 1/25,000 Agency: DCSO Proj. # 2008 Date: 1983

Approx. ~~NAD 83~~ Geographic Position: Latitude 43° 17' 02" Longitude 123° 05' 27"

DESCRIPTION and TO REACH

SKETCH

See monument "POND".

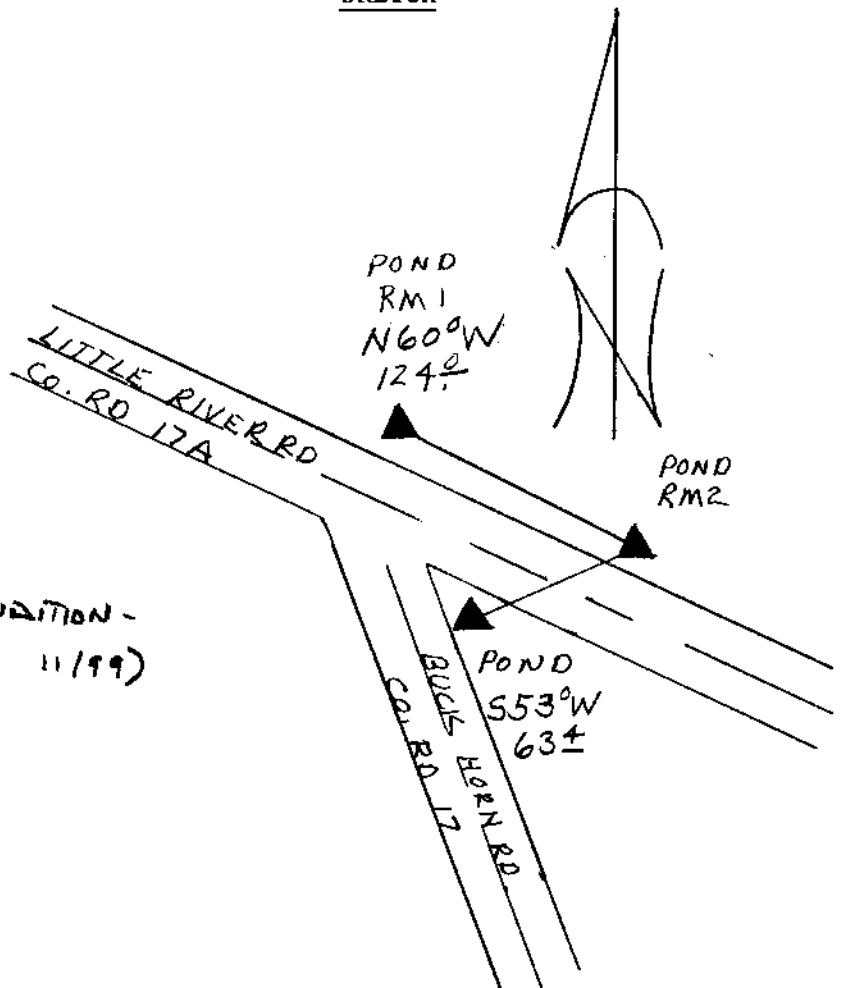

NOTE: BOTH RM'S IN POOR CONDITION -
LOOSE LEAVING (RWS 11/99)

Reference Marks:

Note: For further information, contact the Douglas County Surveyor's Office, Room 205 Douglas County Justice Building, Roseburg, OR 97470. Phone 440-4278. Douglas County residents outside the Roseburg calling area, dial toll free 1-800-452-0991.