

OFFICE OF THE
DOUGLAS COUNTY SURVEYOR

Station: PTS-6
 Set By (Agency): DCSO
 Date Set: 1973
 Recovered By LEM
 Date Recovered 1-82
 Recovered By _____
 Date Recovered _____
 Recovered By _____
 Date Recovered _____

T 32 S, R 5W , Sec 21

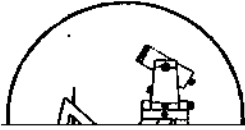

p-059
PTS-6

NAD 415937.35 4171006.98
 83 42°46'25" 123°17'42"

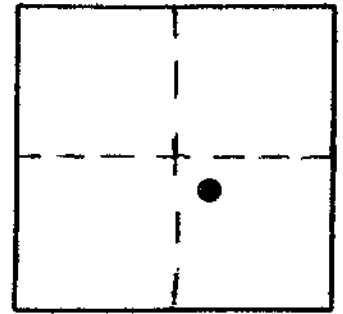

VERTICAL CONTROL

Elevation: 1528.110 NGS Line # _____ USGS Line # _____ OSHD Line # _____
 Precision: 2nd Agency: DCSO Proj. # 2006 Date: 1975

HORIZONTAL CONTROL

South Zone State Plane Coordinates: Y(Northing) 415,973.55 X(Easting) 1,250,047.71
 Precision: 1/25,000 Agency: DCSO Proj. # 2006 Date: 1973
 Approximate Geographic Position: Latitude 42°46'25" Longitude 123°17'38"

DESCRIPTION and TO REACH

SKETCH

Found: A standard DCSO disk set in drill hole in a concrete curb around a water drainage grate. Cap is stamped "PTS-6 1973".

To reach: From I-5 South bound Exit #86 (at Quines Creek) proceed southerly to intersection with Co Rd. #303; proceed southwesterly along Co. Rd. #303, 0.9 mi. to monument on the right.

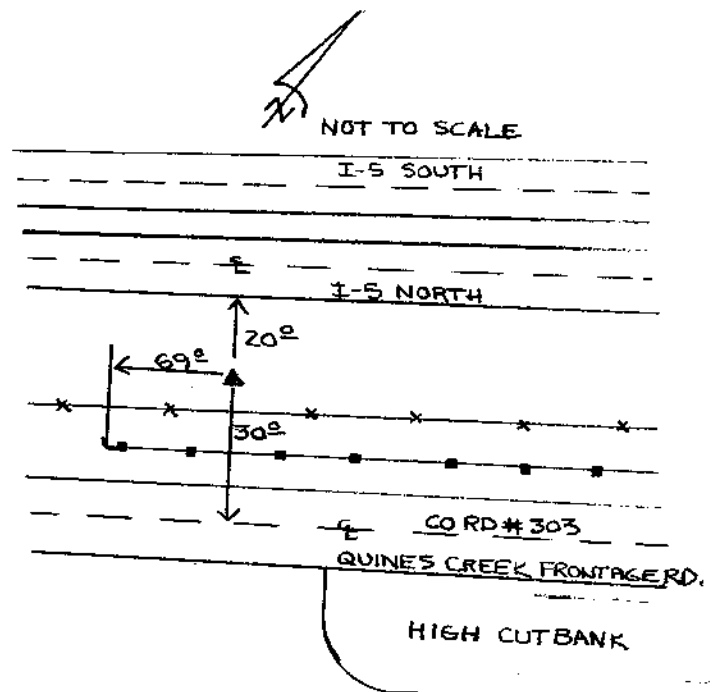

Reference Marks:

Note: For further information, contact the Douglas County Surveyor's Office, Room 205 Douglas County Justice Building, Roseburg, OR 97470. Phone 440-4278. Douglas County residents outside the Roseburg calling area, dial toll free 1-800-452-0991.