

OFFICE OF THE
DOUGLAS COUNTY SURVEYOR

Station: Patrick 1962
 Set By (Agency): USC&GS
 Date Set: 1962
 Recovered By RS-JP
 Date Recovered 1-27-82
 Recovered By _____
 Date Recovered _____
 Recovered By _____
 Date Recovered _____

T 31 S, R 5W , Sec 26

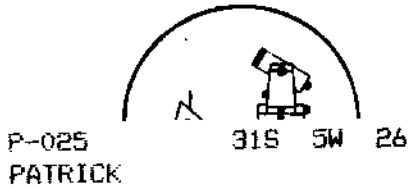
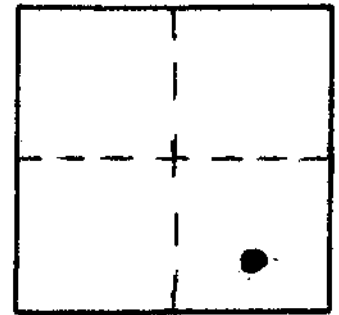

NAD 441282.60 4183447.80
 83 42°50'39" 123°15'6"

VERTICAL CONTROL

Elevation: _____ NGS Line # _____ USGS Line # _____ OSHD Line # _____
 Precision: _____ Agency: _____ Proj. # _____ Date: _____

HORIZONTAL CONTROL OCS 27

South Zone State Plane Coordinates: Y(Northing) 441,318.72 X(Easting) 1,262,489.11
 Precision: 1/25,000 Agency: DCSO Proj. # 2008 Date: 1975
 Approximate Geographic Position: Latitude 42°50'40" Longitude 123°15'02"

DESCRIPTION and TO REACH

Found: A standard USC&GS disk stamped "Patrick 1962". Set in a concrete post protruding 6" above the ground.

To reach: From the intersection of Co. Rd. #36 (Cow Creek Rd.) and I-5 (Freeway exit No. 88 at Azalea) in T32S R5W sec. 2, proceed Northerly along I-5 3.5 miles to monument on the right.

SKETCH

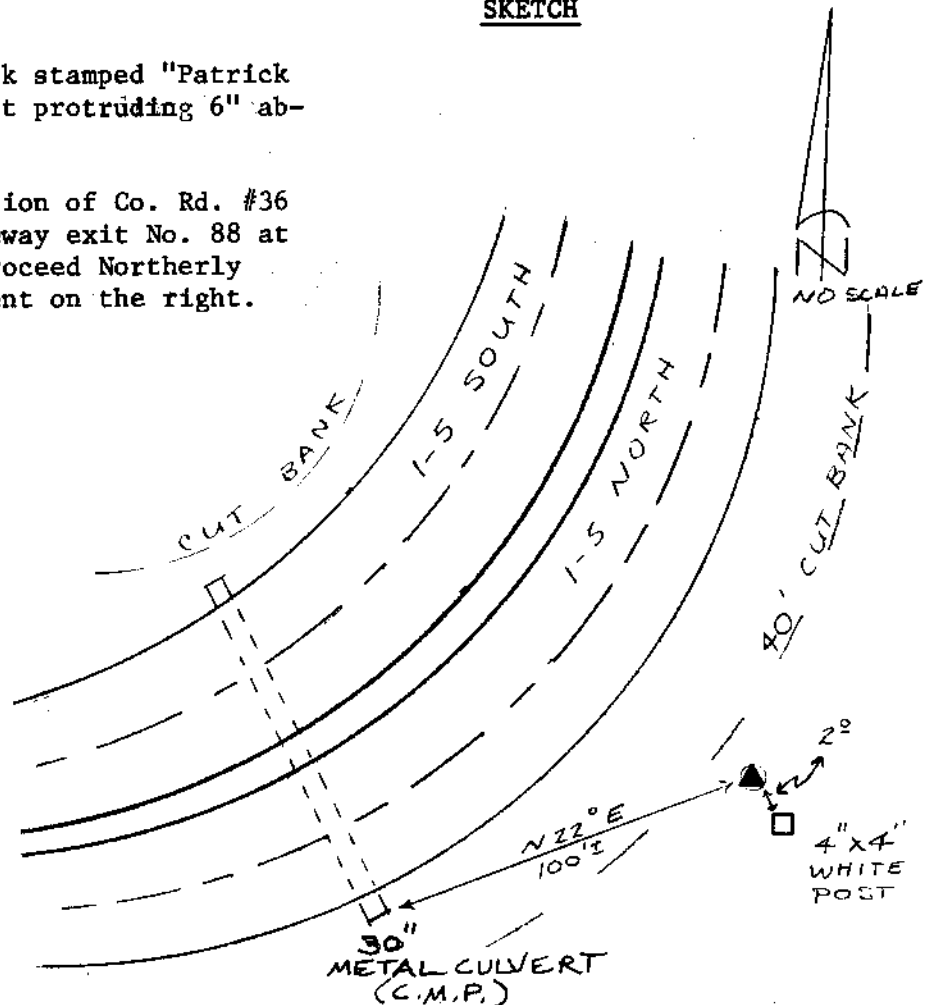

Reference Marks:

Note: For further information, contact the Douglas County Surveyor's Office, Room 205 Douglas County Justice Building, Roseburg, OR 97470. Phone 440-4278. Douglas County residents outside the Roseburg calling area, dial toll free 1-800-452-0991.