

OFFICE OF THE
DOUGLAS COUNTY SURVEYOR

p-020
PACIFIC

22S 5W 8

NAD 743563.89 4177990.45
83 43°40'22" 123°18'36"

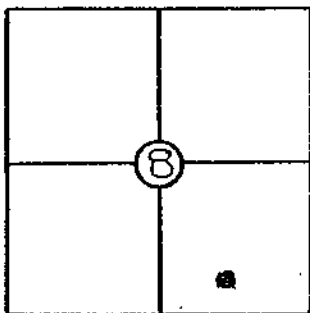

T 22 S, R 5 W Sec. 8

Station: PACIFIC

Set By (Agency): DCSO

Date: 1979

VERTICAL CONTROL

Elevation: _____ NGS(USC&GS) Line # _____ USGS Line # _____

Order
Of Precision _____ Agency: _____ Proj. #: _____ Date: _____

HORIZONTAL CONTROL

Oregon State Plane Coordinates: Y(Northing) 743,598.73 X(Easting) 1,257,029.81
(South Zone)

Order
Of Precision 1/25,000 Agency: DCSO Proj. #: 2008 Date: 1979
(North County)

Approximate Geographic Position: Latitude= 43° 40' 22" Longitude= 123° 18' 31"

DESCRIPTION: A standard DCSO brass cap in
conc. filled bell tile 6"x39" buried flush
with ground. 31 ft. West of Hwy 99 center-
line, 22 ft. South of Southerly edge of
driveway, 18 ft. NE of 4'x8' wooden sign
"WELCOME TO DRAIN PACIFIC GATEWAY".

Pacific Rm 1 is a brass cap in old gas pump
island at south end. Bearing N25°36'37"E 57.69ft.
from the monument. RM 2 is a brass cap drilled in
conc. base of R.R. cross arm marker #6094
(East side of tracks) and 20ft. S. of private
R.R. crossing centerline. RM 2 bears S9°16'39"W
256.8ft. from Pacific .

VICINITY: Northerly city limits of Drain
intersection of Hwy. 99 and Krewson St.

SKETCH

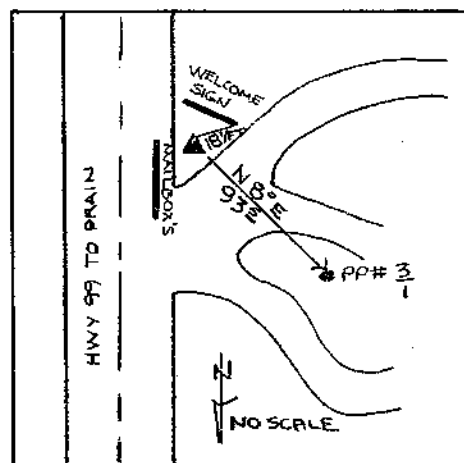

NOTE: For Possible Further Information On This Station, Please Contact The Douglas County Surveyors' Office, Rm. 205 Douglas County Justice Bldg., Roseburg, OR. 97470 Phone 672-3311 Ext. 272. Douglas County residents outside the Roseburg calling area dial toll free 1-800-452-0991.