

OFFICE OF THE
DOUGLAS COUNTY SURVEYOR

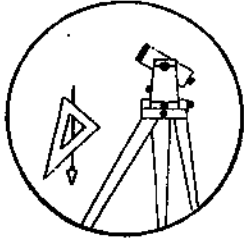

Station: P 612
Set By (Agency): OSHD
Date Set: 1967
Recovered By GQ-RS
Date Recovered 1-20-82
Recovered By _____
Date Recovered _____
Recovered By _____
Date Recovered _____

T 21 S, R 12W , Sec 24

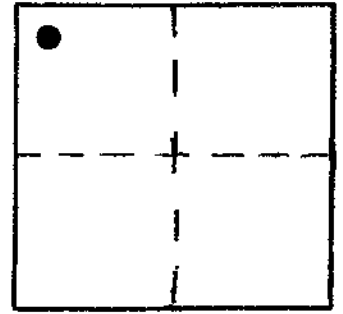

P 018

VERTICAL CONTROL

Elevation: 17.44 NGS Line # _____ USGS Line # _____ OSHD Line # 93C
Precision: 3rd Agency: DCSO Proj. # 2006 Date: 1989
(River Floodplain)

HORIZONTAL CONTROL

South Zone State Plane Coordinates: Y(Northing) _____ X(Easting) _____
Precision: _____ Agency: _____ Proj. # _____ Date: _____
Approximate Geographic Position: Latitude _____ Longitude _____

DESCRIPTION and TO REACH

SKETCH

Found: A standard St. Hwy. Dept. disk marked "P612 1967" set in bridge curb 1.5 ft. in from the most northerly corner of bridge over slough.

To reach: From the intersection of Co. Rd. #195 & Co. Rd. #48 (in sec. 19 T21S R11W) proceed Southwesterly along Rd. #48, 0.8 mi. to monument on the right.

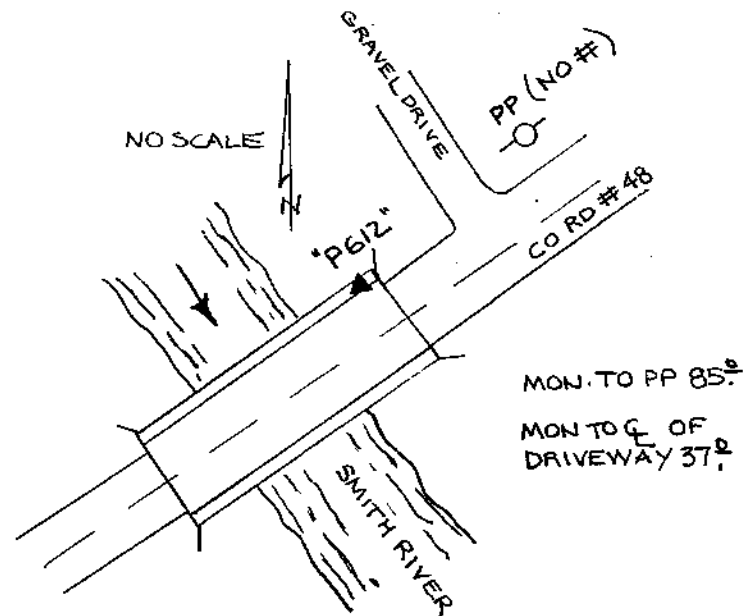

Reference Marks:

Note: For further information, contact the Douglas County Surveyor's Office, Room 205 Douglas County Justice Building, Roseburg, OR 97470. Phone 440-4278. Douglas County residents outside the Roseburg calling area, dial toll free 1-800-452-0991.