

OFFICE OF THE
DOUGLAS COUNTY SURVEYOR



p-013
P 496 RESET

NAD 83 637881.86 43°22'38" 4118848.03 123°31' 8"

Station: P 496 Reset
Set By (Agency): USC&GS
Date Set: 1968
Recovered By GQ-JP-RWS
Date Recovered 1-26-82
Recovered By RW/SF 2000
Date Recovered _____
Recovered By _____
Date Recovered _____

T 25 S, R 7W , Sec 22

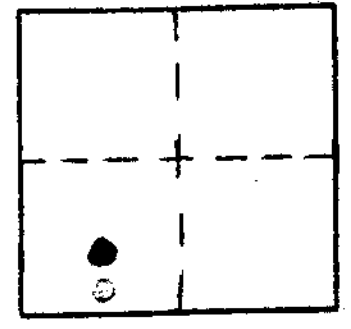

VERTICAL CONTROL

Elevation: ~~341.049~~ 340^{S7} NGS Line # 98 USGS Line # _____ OSHD Line # _____

Precision: 3rd Agency: DCSO Proj. # CS 66/53 Date: 3/2000

HORIZONTAL CONTROL 1968 ELEV (341.049) CHANGED IN DESO COMP AS 3/2000 - POSTED INTO RECORD 12/2002

South Zone State Plane Coordinates: Y(Northing) 637,916.47 X(Easting) 1,197,889.14

Precision: 1/25,000 Agency: DCSO Proj. # 2006 Date: 1968

Approximate Geographic Position: Latitude 43°22' 39" Longitude 123°31'04"

DESCRIPTION and TO REACH

A standard USC&GS disk stamped "P496 RESET 1968" set in an 8" sq. concrete post, protruding 5" from the ground. Witness sign is South 1' from monument.

To reach: From the intersection of Hubbard Cr. Rd. (Co. Rd. #6) and Melqua Rd (Co. Rd. # 13A) in S. 26, T25S R7W, proceed Westerly 2.1 mi. to station on the right

SKETCH

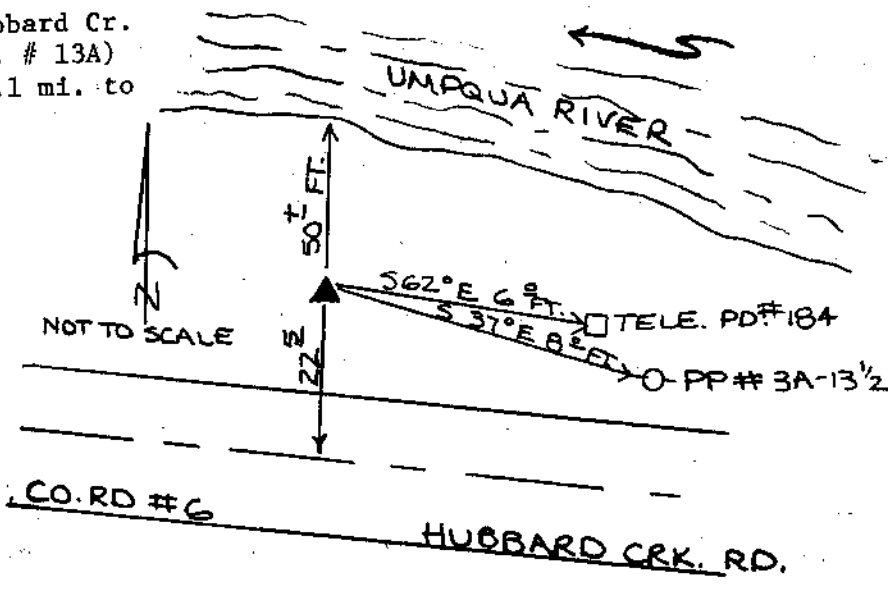

Reference Marks: P 496 RM 1&2 are either gone or paved over.

Note: For further information, contact the Douglas County Surveyor's Office, Room 205 Douglas County Justice Building, Roseburg, OR 97470. Phone 440-4278. Douglas County residents outside the Roseburg calling area, dial toll free 1-800-452-0991.



3. 7. 2000