

OFFICE OF THE
DOUGLAS COUNTY SURVEYOR

Station: P 253
Date Set: 1934
Set By (Agency): USC & GS
DCSO Designation: P-007
Date Recovered: 1993
Recovered By: LEM TF
Date Recovered: _____
Recovered By: _____
Date Recovered: _____
Recovered By: _____

T26W R4W Sec. 14

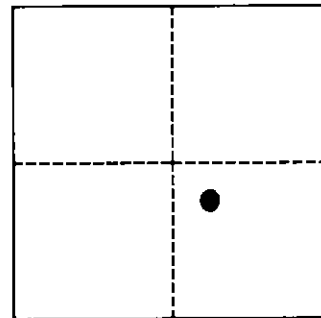
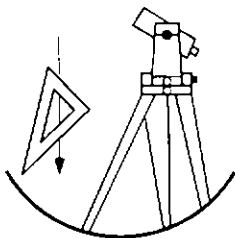

VERTICAL CONTROL

NGVD 29 Elevation: 662.633 FEET NAVD 88 Elevation: 203.057 METERS
NGS Line # _____ USGS LINE # 94 OSHD Line # _____ FILE # _____
Precision: 1ST ORDER Agency: USC&GS Proj: _____ Date: 1961

HORIZONTAL CONTROL

O.C.S. 27 Y(Northing): _____ O.C.S. 83 Y(Northing): _____
(South Zone) X(Easting): _____ (South Zone) X(Easting): _____
Precision: _____ Agency: _____ Proj: _____ Date: _____
Approx. O.C.S. 27 Geographic Position: Latitude: 43°18'21" Longitude: 123°08'02"
Approx. O.C.S. 83 Geographic Position: Latitude: _____ Longitude: _____

Found: A State Survey disk set in a 12" sq. concrete post stamped "USC & GS State Survey Sta #P253 ELEV 662 FT 1934" with witness post alongside.

To reach: From the intersection of North Bank Rd. (Co. Rd. #200) and Wildriver Dr. (Co. Rd. #4B-3) in T26S R4W Sec. 13. Continue on Wildriver Dr. 0.6 miles to monument on the left side of the road.

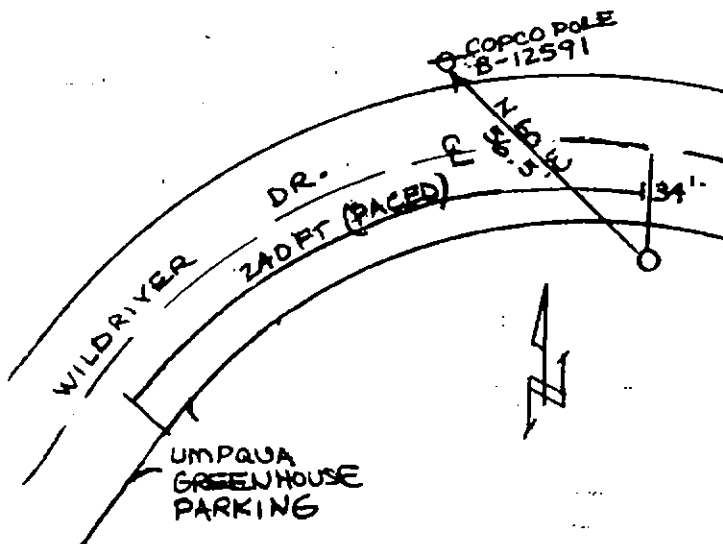

Note: For further information contact the Douglas County Surveyors Office, Room 205 Douglas County Justice Building, Roseburg, OR 97470. Phone 440-4272. Douglas County Residents outside Roseburg calling area, dial toll free 1-800-477-0991.