

OFFICE OF THE
DOUGLAS COUNTY SURVEYOR

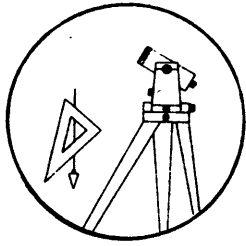

P.004

Station: P 76 T 29 S, R 8 W, Sec 9
Set By (Agency): USC&GS
Date Set: 1931
Recovered By PB,RS
Date Recovered 11/16/83
Recovered By _____
Date Recovered _____
Recovered By _____
Date Recovered _____

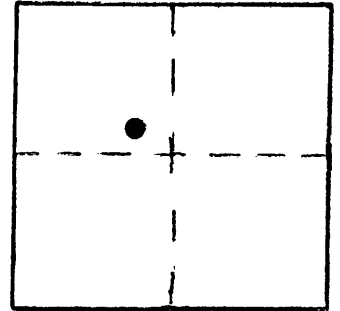

VERTICAL CONTROL NGVD29

Elevation: 1471.697 NGS Line # 27 USGS Line # _____ OSHD Line # _____
Precision: 2nd Agency: USC&GS Proj. # _____ Date: 1957

HORIZONTAL CONTROL

South Zone State Plane Coordinates: Y(Northing) _____ X(Easting) _____
Precision: _____ Agency: _____ Proj. # _____ Date: _____
Approximate Geographic Position: Latitude _____ Longitude _____

DESCRIPTION and TO REACH

SKETCH

DESCRIPTION:

A disk stamped "P 76 1931" set flush
in a 10 in. square concrete post protruding
10 in. above ground.

TO REACH:

Go to intersection of State Hwy. 42
and BLM Rd. #29-8-9.0 in T29S,R8W,Sec.9.

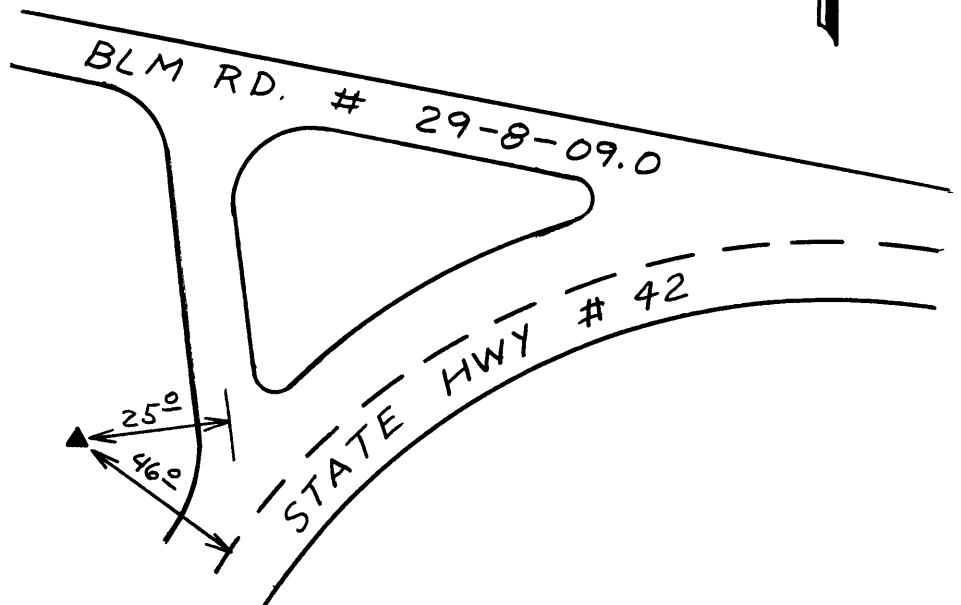

Reference Marks:

Note: For further information, contact the Douglas County Surveyor's Office, Room 205
Douglas County Justice Building, Roseburg, OR 97470. Phone 440-4278. Douglas
County residents outside the Roseburg calling area, dial toll free 1-800-452-0991.