

DOUGLAS COUNTY SURVEYOR'S OFFICE

Designation: 0-042 Station: ODOT CONTROL 101 T 28 S R 6 W S 21 AC 1/4 NE

Date Set: N/A Set by (Agency): O.D.O.T.

Date Recovered: AUG. 2005 Recovered by: S. FLAUSE; J. PIKE

- Found New Reset
 Not Found Referenced Destroyed

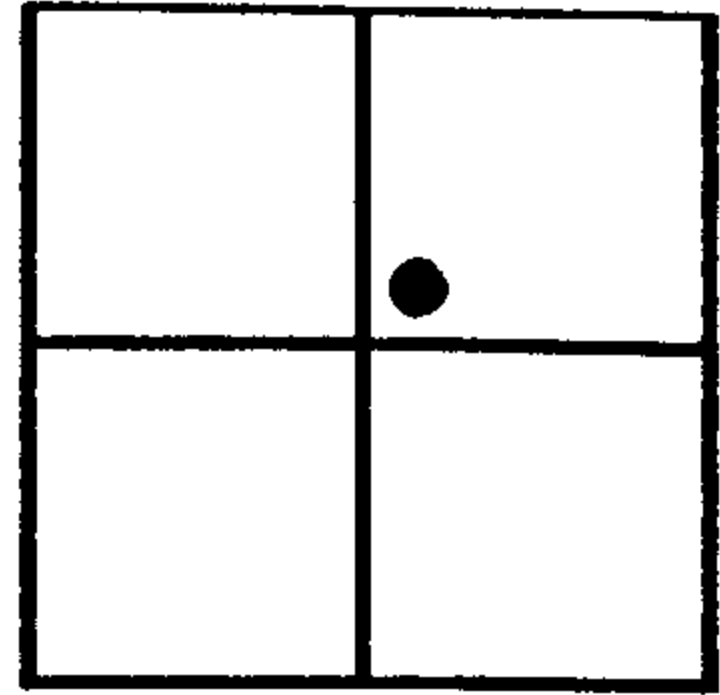

VERTICAL CONTROL

NGVD 29 Elevation: 533.36 Feet File # _____
 Precision: 3rd Agency: DCSO Project: CS 67/17 Date: 2005
 NAVD 88 Elevation: _____ Meters File # _____
 Precision: _____ Agency: _____ Project: _____ Date: _____

HORIZONTAL CONTROL - south zone

N 543887.0 E 4143719.9 Datum/Adj.: NAD 83 Precision: 615
 Lat: 43°07'19.0" Long: 123°24'47.2" Agency: DCSO File # CS 67/17 Date: 8/05
 N _____ E _____ Datum/Adj.: _____ Precision: _____
 Lat: _____ Long: _____ Agency: _____ File # _____ Date: _____
 N _____ E _____ Datum/Adj.: _____ Precision: _____
 Lat: _____ Long: _____ Agency: _____ File # _____ Date: _____
 N _____ E _____ Datum/Adj.: _____ Precision: _____
 Lat: _____ Long: _____ Agency: _____ File # _____ Date: _____

DESCRIPTION AND TO REACH

A 1/8" DIA. COPPER DISK STAMPED
 "O.D.O.T. CONTROL 101" SET
 FLUSH IN SIDEWALK.

MONUMENT LIES IN TRAFFIC ISLAND
 (WITH STATUE OF CHEETAH) AT THE
 INTERSECTION OF MAIN ST. (HWY 99)
 AND SW DOUGLAS AVE. (HWY 42)
 IN DOWNTOWN WINSTON IN THE
 NE 1/4 OF SECTION 21, T28S, R6W.

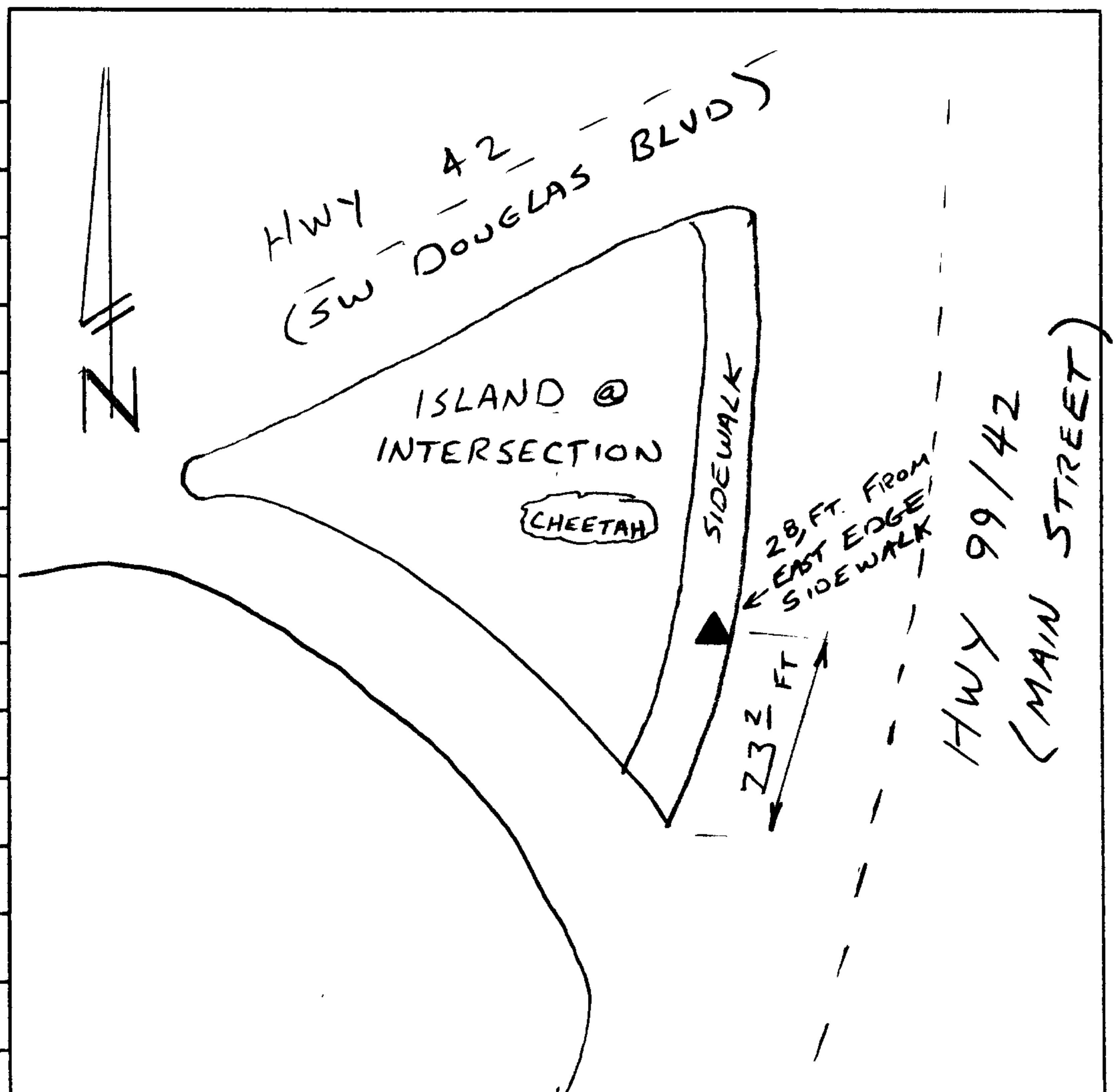

PHOTO FILE NAME

LOCATION

GPS FILE - MO81714A

PICTURE FILE - # 100-1256

PROCESSED BY: _____

DATE: _____

Washburn
Portland
Willard
Astoria
19
3
199
S
7

DO NOT
ENTER

Wynia Park
Cascadia

6. 2. 1999