

OFFICE OF THE
DOUGLAS COUNTY SURVEYOR

Station: N 747

T31S R5W Sec. 2

Date Set: 1987

Set By (Agency): NGS

DCSO Designation: N-067

Date Recovered: 8-93

Recovered By: RWS S.JF

Date Recovered: _____

Recovered By: _____

Date Recovered: _____

Recovered By: _____

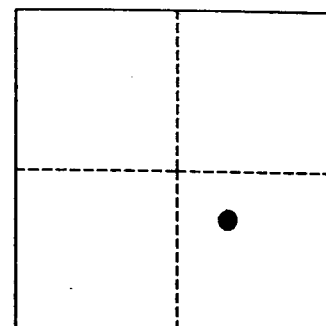
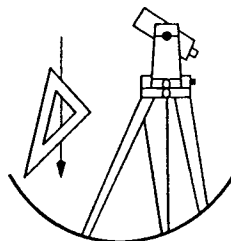

VERTICAL CONTROL

~~NGVD 29~~ ^{NAVD 88} Elevation: 912.940 FEET NAVD 88 Elevation: 278.264 METERS

NGS Line # L25042 USGS LINE # _____ OSHD Line # _____ FILE # _____

Precision: 1ST ORDER Agency: NGS Proj: _____ Date: 1988

HORIZONTAL CONTROL

O.C.S. 27 Y (Northing): _____ O.C.S. 83 Y (Northing): 463110

(South Zone) X (Easting): _____ (South Zone) X (Easting): 4183938

Precision: GISSCALED Agency: DCSO Proj: _____ Date: 2014

Approx. O.C.S. 27 Geographic Position: Latitude: 42°54'18" Longitude: 123°15'06"

Approx. O.C.S. 83 Geographic Position: Latitude: _____ Longitude: _____

Found: A 3 - 5/8 inch diameter NGS disk stamped "N 747 1987" set in rock cut bank approx. 5 feet above ground.

To reach: From the intersection of I-5 and Canyon Creek Rd. (Co. Rd. #301) in T31S R5W Sec2 (exit 95) proceed northwesterly along I-5, 0.5 mile to monument on right at mile post 96.3

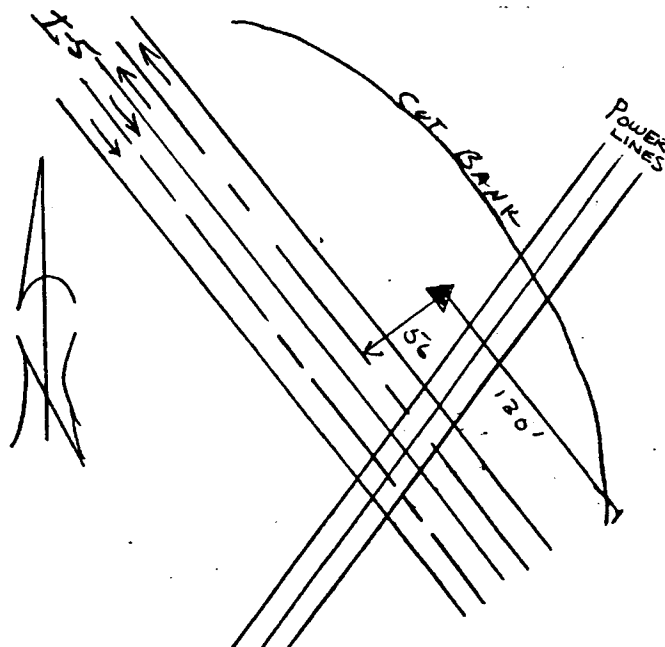

Note: For further information contact the Douglas County Surveyors Office, Room 205 Douglas County Justice Building, Roseburg, OR 97470. Phone 440-4272. Douglas County Residents outside Roseburg calling area, dial toll free 1-800-477-0991.