

OFFICE OF THE  
DOUGLAS COUNTY SURVEYOR

Station: N 741X  
 Date Set: 1987  
 Set By (Agency): NGS  
 DCSO Designation: N-066  
 Date Recovered: 8-93  
 Recovered By: RWS.SJF  
 Date Recovered: \_\_\_\_\_  
 Recovered By: \_\_\_\_\_  
 Date Recovered: \_\_\_\_\_  
 Recovered By: \_\_\_\_\_

T29S R8W Sec. 16

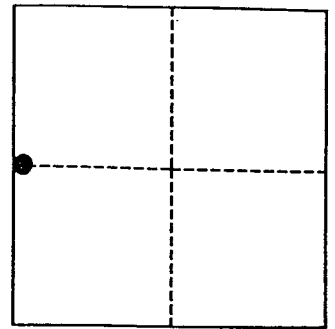
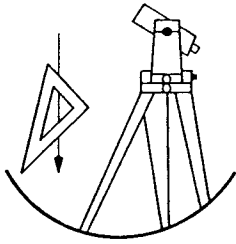

VERTICAL CONTROL

~~NAVD 88~~  
 NAVD 88 Elevation: 1336.168 FEET      NAVD 88 Elevation: 407.264 METERS  
 NGS Line # 125034      USGS LINE # \_\_\_\_\_      OSHD Line # \_\_\_\_\_      FILE # \_\_\_\_\_  
 Precision: 1ST ORDER      Agency: NGS      Proj: \_\_\_\_\_      Date: 1988

HORIZONTAL CONTROL

O.C.S. 27      Y(Northing): \_\_\_\_\_      O.C.S. 83      Y(Northing): 519137  
 (South Zone)      X(Easting): \_\_\_\_\_      (South Zone)      X(Easting): 4076416  
 Precision: GIS SCALED      Agency: DCSO      Proj: \_\_\_\_\_      Date: 2014  
 Approx. O.C.S. 27 Geographic Position:      Latitude: 43°02'49"      Longitude: 123°39'40"  
 Approx. O.C.S. 83 Geographic Position:      Latitude: \_\_\_\_\_      Longitude: \_\_\_\_\_

Found: A 3 - 5/8 inch diameter NGS disk stamped "N 741X 1987" set flush in low 5 X 28 foot rock out-crop.

To reach: From the intersection of Camas Valley Transfer Site Rd. (Co. Rd. #214) and State Hwy 42 in T29S R8W Sec17 proceed northeasterly along Hwy 42 approx. 0.40 miles to milepoint ~~57.35~~ and monument on left.

56.0

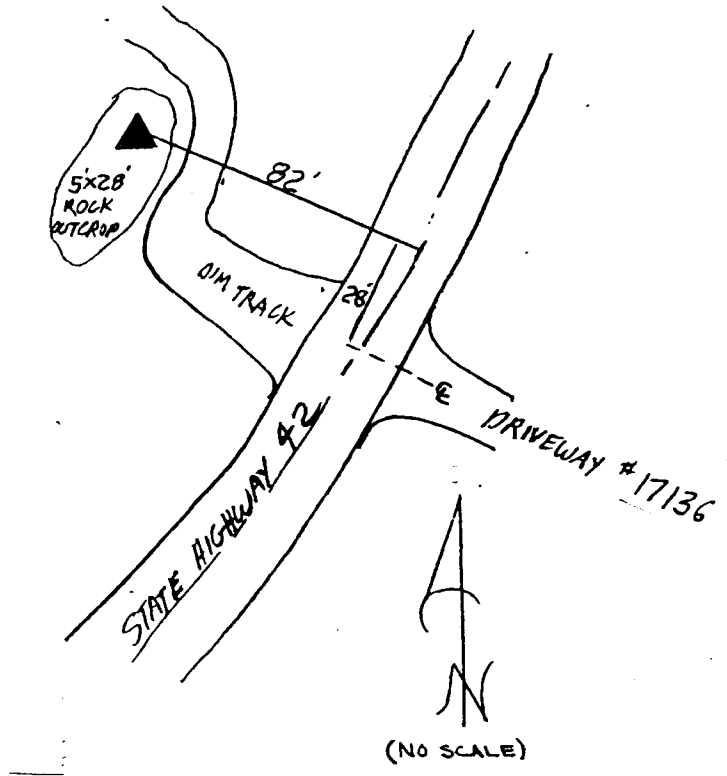

Note: For further information contact the Douglas County Surveyors Office, Room 205 Douglas County Justice Building, Roseburg, OR 97470. Phone 440-4272. Douglas County Residents outside Roseburg calling area, dial toll free 1-800-477-0991.