

OFFICE OF THE
DOUGLAS COUNTY SURVEYOR

Station: NU-22 T 26 S, R 4 W , Sec 17

Set By (Agency): DCSO

Date Set: 1972

Recovered By RWS,SJF

Date Recovered 11/16/85

Recovered By _____

Date Recovered _____

Recovered By _____

Date Recovered _____

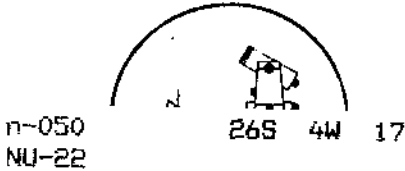
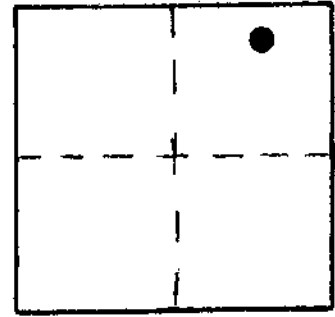

NAD 611953.86 4204731.69
83 43°18'51" 123°11'34"

VERTICAL CONTROL **NGVD 29**

Elevation: 706.901 NGS Line # _____ USGS Line # _____ OSHD Line # _____
Precision: 2nd Agency: DCSO Proj. # 2006 Date: 1972

HORIZONTAL CONTROL **OCS 27**

South Zone State Plane Coordinates: Y(Northing) 611,989.18 X(Easting) 1,283,772.22
Precision: 1/25,000 Agency: DCSO Proj. # 2006 Date: 1972

Approximate Geographic Position: Latitude 43°18'52" Longitude 123°11'30"

DESCRIPTION and TO REACH

A DCSO disk stamped "NU-22 1972" set in a concrete filled 8 inch diameter concrete belltile, protruding 10 inches above ground.

TO REACH:

From the intersection of Diamond Lake Highway (State Highway #138) and North Bank Rd. (Co. Rd. #200) in T26S,R4W,Sec.12, proceed westerly along North Bank Road approx. 4.3 miles to monument and private road on left. Monument lies at top of cut bank 5 ft. higher than road.

SKETCH

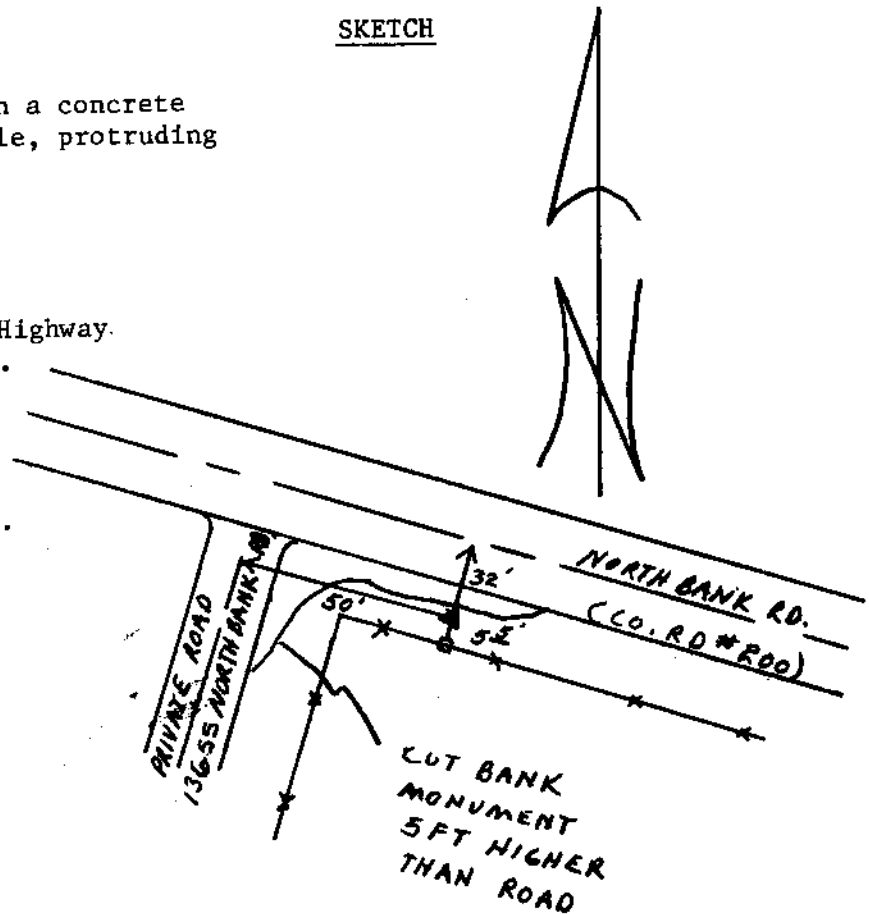

Reference Marks:

Note: For further information, contact the Douglas County Surveyor's Office, Room 205 Douglas County Justice Building, Roseburg, OR 97470. Phone 440-4278. Douglas County residents outside the Roseburg calling area, dial toll free 1-800-452-0991.