

OFFICE OF THE
DOUGLAS COUNTY SURVEYOR

Station: NU-20 T 26 S, R 4 W, Sec 7

Set By (Agency): DCSO

Date Set: 1972

Recovered By RWS,SJF

Date Recovered 9/16/85

Recovered By _____

Date Recovered _____

Recovered By _____

Date Recovered _____

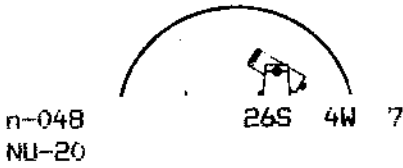

NAD 613471.60 4199339.59
83 43°19' 4" 123°12'48"

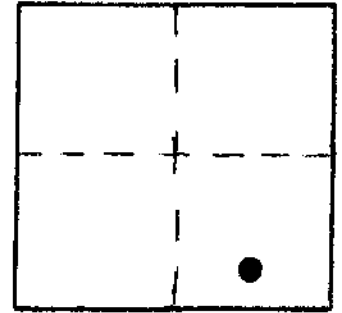

VERTICAL CONTROL *NGVD 29*

Elevation: 691.634 NGS Line # _____ USGS Line # _____ OSHD Line # _____

Precision: 2nd Agency: DCSO Proj. # 2006 Date: 1972

HORIZONTAL CONTROL *OCS 27*

South Zone State Plane Coordinates: Y(Northing) 613,506.87 X(Easting) 1,278,380.21

Precision: 1/25,000 Agency: DCSO Proj. # 2006 Date: 1972

Approximate Geographic Position: Latitude 43°19'05" Longitude 123°12'44"

DESCRIPTION and TO REACH

SKETCH

A DCSO disk stamped "NU-20 1972" set flush in rock outcrop.

TO REACH:

From the intersection of Diamond Lake Highway (State Highway #138) and North Bank Road (Co.Rd. #200) in T26S,R4W,Sec.12, proceed westerly along North Bank Rd. approx. 7.2 miles to driveway and monument on left.

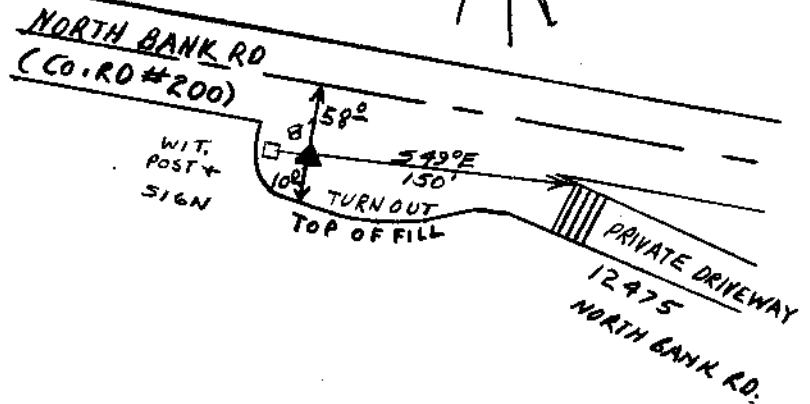

Reference Marks:

Note: For further information, contact the Douglas County Surveyor's Office, Room 205 Douglas County Justice Building, Roseburg, OR 97470. Phone 440-4278. Douglas County residents outside the Roseburg calling area, dial toll free 1-800-452-0991.