

OFFICE OF THE
DOUGLAS COUNTY SURVEYOR

Station: NU-17
 Set By (Agency): DCSO
 Date Set: 1972
 Recovered By RWS, SJF
 Date Recovered 9/16/85
 Recovered By _____
 Date Recovered _____
 Recovered By _____
 Date Recovered _____

T 26 S, R 5 W , Sec 24



n-045
NU 17

NAD 605488.30 4193569.51
 83 43°17'44" 123°14' 2"

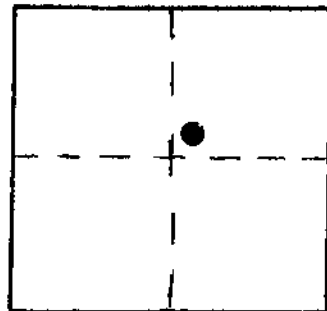

VERTICAL CONTROL NGVD 29

Elevation: 642.100 NGS Line # _____ USGS Line # _____ OSHD Line # _____
 Precision: 2nd Agency: DCSO Proj. # 2006 Date: 1972

HORIZONTAL CONTROL OCS 27

South Zone State Plane Coordinates: Y(Northing) 605,523.54 X(Easting) 1,272,610.32
 Precision: 1/25,000 Agency: DCSO Proj. # 2006 Date: 1972
 Approximate Geographic Position: Latitude 43°17'44" Longitude 123°13'58"

DESCRIPTION and TO REACH

SKETCH

A DCSO disk stamped "NU-17 1972" set in a concrete filled 8 in. diam. concrete belltile, protruding 8 in. above ground.

TO REACH:

From the intersection of State Highway 99 and North Bank Rd. (Co. Rd. #200) in T26S, R5W, Sec. 18, proceed westerly along North Bank Rd. approx. 8.4 miles to monument on left.

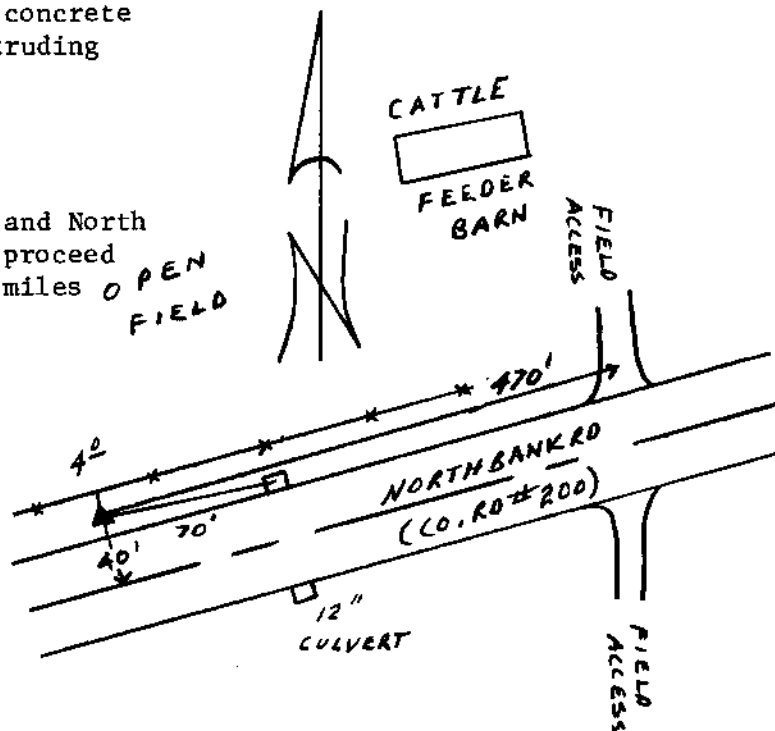

Reference Marks:

Note: For further information, contact the Douglas County Surveyor's Office, Room 205 Douglas County Justice Building, Roseburg, OR 97470. Phone 440-4278. Douglas County residents outside the Roseburg calling area, dial toll free 1-800-452-0991.