

**DOUGLAS COUNTY SURVEYOR'S OFFICE**

Designation: M-114 Station: MACD T 27S R 6W S 11 ¼ A

Date Set: 2008

Set by (Agency): AA SURVEYING INC.

Date Recovered: 1/16/08

Recovered by: SJF, JAP

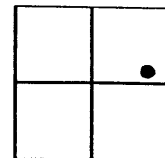

- Found
- New
- Reset
- Not Found
- Referenced
- Destroyed

VERTICAL CONTROL

NGVD 29 Elevation: 465.34 Feet File # 67/026  
 Precision: 3RD. Agency: DCSO Project: 2007 Date: 2008  
 NAVD 88 Elevation: \_\_\_\_\_ Meters File # \_\_\_\_\_  
 Precision: \_\_\_\_\_ Agency: \_\_\_\_\_ Project: \_\_\_\_\_ Date: \_\_\_\_\_

HORIZONTAL CONTROL - south zone

N 58.5284.11 E 4156962.79 Datum/Adj.: 1983 Precision: GIS  
 Lat: 43°14'12.15" Long: 123°22'07.81" Agency: DCSO File # M01162A Date: 1/16/08  
 N \_\_\_\_\_ E \_\_\_\_\_ Datum/Adj.: 1927 Precision: GIS  
 Lat: 43°14'12.73" Long: 123°22'03.55" Agency: DCSO File # 67/026 Date: 1/16/08  
 N \_\_\_\_\_ E \_\_\_\_\_ Datum/Adj.: \_\_\_\_\_ Precision: \_\_\_\_\_  
 Lat: \_\_\_\_\_ Long: \_\_\_\_\_ Agency: \_\_\_\_\_ File # \_\_\_\_\_ Date: \_\_\_\_\_  
 N \_\_\_\_\_ E \_\_\_\_\_ Datum/Adj.: \_\_\_\_\_ Precision: \_\_\_\_\_  
 Lat: \_\_\_\_\_ Long: \_\_\_\_\_ Agency: \_\_\_\_\_ File # \_\_\_\_\_ Date: \_\_\_\_\_

DESCRIPTION AND TO REACH

A 1 3/8 INCH DIAMETER UNMARKED  
AA SURVEYING BRASS CAP WITH  
NEW STAMPING MACD 2008 SET  
NEARLY FLUSH IN CONCRETE CURB-  
ING AT SOUTHERLY END OF, AND  
ON WESTLY SIDE OF, CONCRETE  
BRIDGE FOR RENANN STREET  
OVER NEWTON CREEK.  
FROM THE INTERSECTION OF  
STEWART PARKWAY AND RENANN  
STREET IN THE NE QUARTER OF  
T27S, R6W, SEC. 11 PROCEED  
SOUTHEAST ALONG RENANN ST.  
0.10 MILES TO MONUMENT ON  
RIGHT.

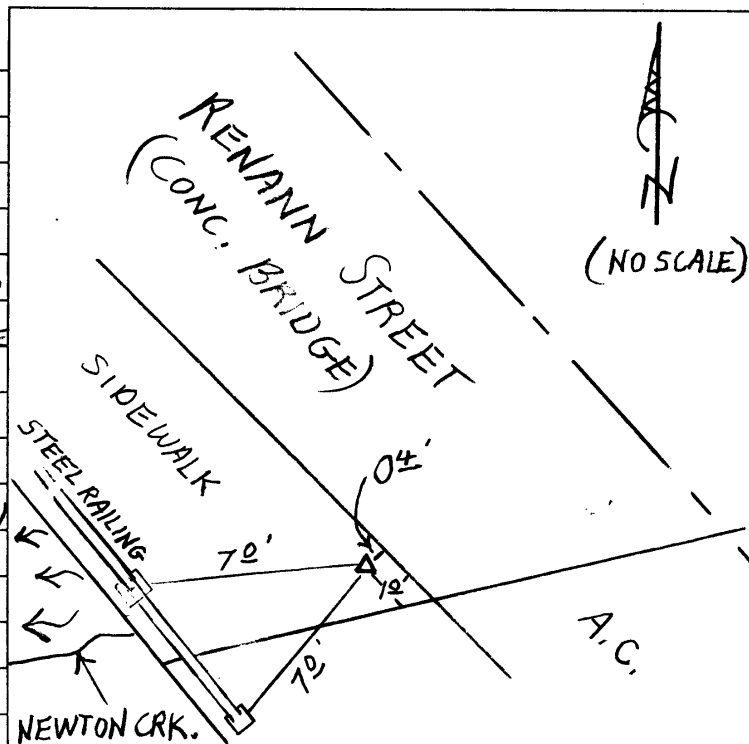





7. 21. 1999