

OFFICE OF THE
DOUGLAS COUNTY SURVEYOR

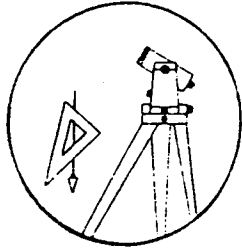

DESIGNATION **M-049**

Station: MM
 Date Set: 1983
 Set By (Agency): LS 866
 Date Recovered: 1/7/91
 Recovered By: SJF - TF
 Date Recovered: _____
 Recovered By: _____
 Date Recovered: _____
 Recovered By: _____

T 29 S, R 5W, Sec 22

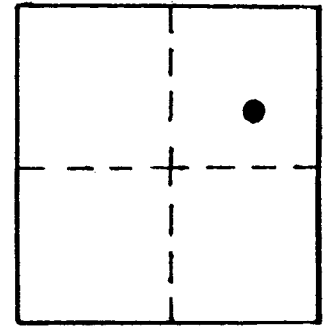

VERTICAL CONTROL

Elevation: 647.643 NGS Line # _____ USGS Line # _____ OSHD Line # _____
 Precision: 2nd Agency: DCSO Proj. # 2007 Date: 1990

HORIZONTAL CONTROL CORPSCON6 NAVD88 651,065 FT. **CS 66143**

South Zone O.C.S. 27: Y(Northing) _____ X(Easting) _____

South Zone O.C.S. 83: Y(Northing) 511322 X(Easting) 4180712

Precision: GIS SCALED Agency: DCSO Proj. # _____ Date: 2014

Approx. NAD ⁸³ Geographic Position: Latitude 43°02'11" Longitude 123°16'09"
 27

DESCRIPTION and TO REACH

A disk stamped "MM LS 866 1983" set in a 1' x 1' concrete block marked 1983 protruding 4" above ground.

To reach:

From the intersection of South Myrtle Rd. (Co. Rd. #18) and North Myrtle Rd. (Co. Rd. #15) in T29S, R5W, sec. 22 proceed northerly along North Myrtle Rd. 0.75 mi. to monument on the right.

SKETCH

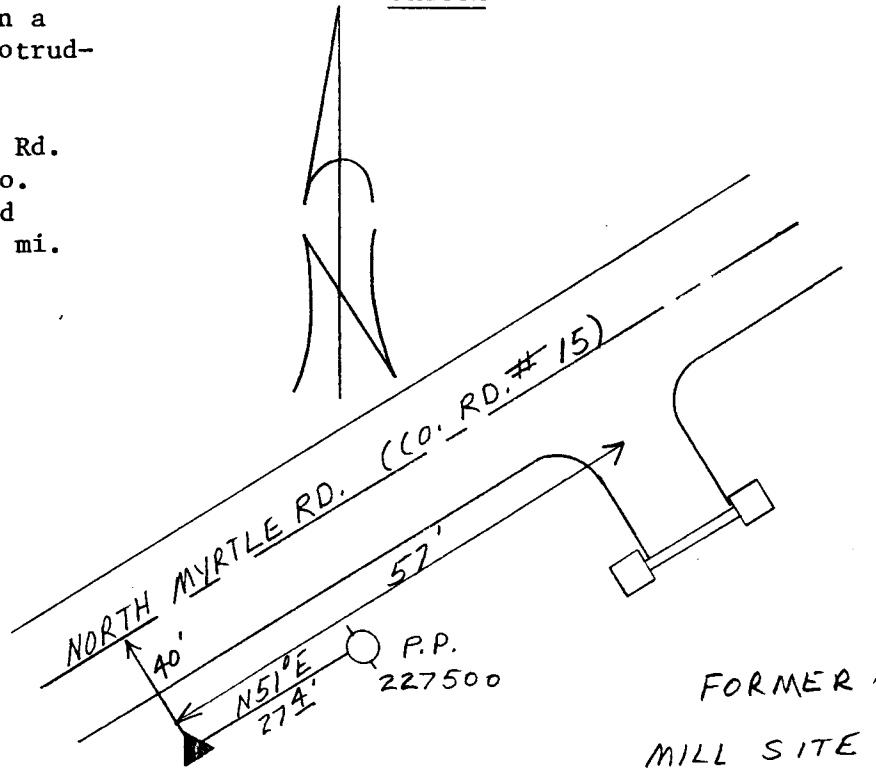

FORMER
MILL SITE

Reference Marks:

Note: For further information, contact the Douglas County Surveyor's Office, Room 205 Douglas County Justice Building, Roseburg, OR 97470. Phone 440-4278. Douglas County residents outside the Roseburg calling area, dial toll free 1-800-452-0991.