

OFFICE OF THE
DOUGLAS COUNTY SURVEYOR

Station: MEDFORD
 Set By (Agency): DCSO
 Date Set: 1976
 Recovered By RS, JP
 Date Recovered 8/26/83
 Recovered By _____
 Date Recovered _____
 Recovered By _____
 Date Recovered _____

T 27 S, R 6 W, Sec 25

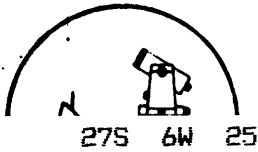
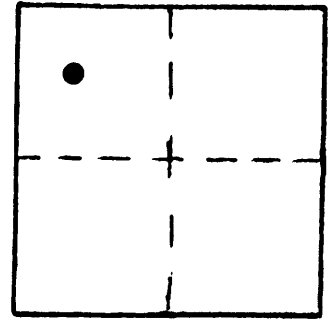

m-036
MEDFORD

NAD 570398.09 4158457.82
 83 43°11'46" 123°21'41"

VERTICAL CONTROL

Elevation: _____ NGS Line # _____ USGS Line # _____ OSHD Line # _____
 Precision: _____ Agency: _____ Proj. # _____ Date: _____

HORIZONTAL CONTROL OCS 27

South Zone State Plane Coordinates: Y(Northing) 570,433.28 X(Easting) 1,237,499.45
 Precision: 1/15,000 Agency: DCSO Proj. # 6014-1 (CS 59/5) Date: 1976
 Approximate Geographic Position: Latitude 43°11'46" Longitude 123°21'36"

DESCRIPTION and TO REACH

DESCRIPTION:

A DCSO disk stamped "MEDFORD 1976"
 set flush in a 12X12X18 in. concrete
 monument.

TO REACH:

From the overcrossing of I-5 and
 Frontage Rd. (exit 123, Fair grounds interchange)
 proceed southerly along Frontage Rd. approx. 0.2
 miles to monument on right.

SKETCH

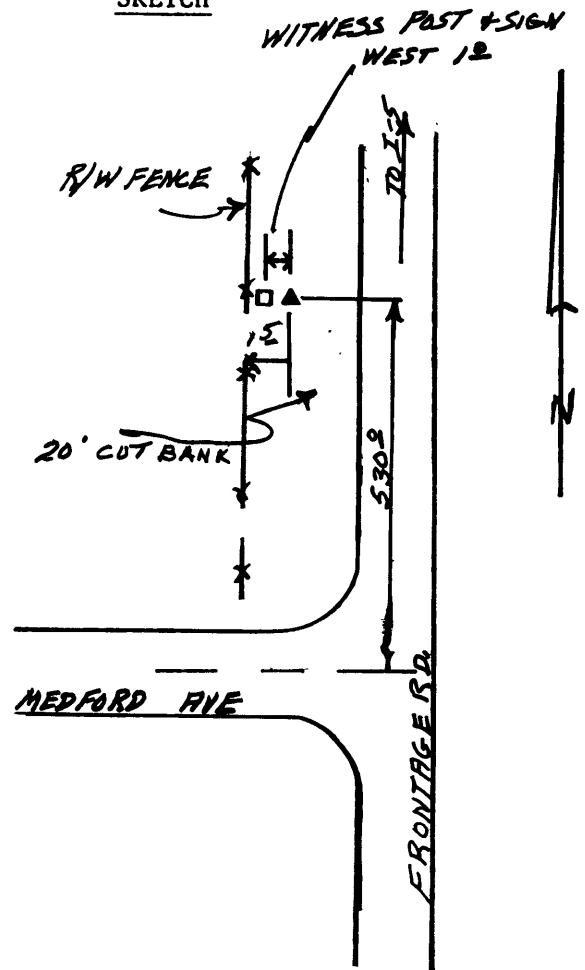

Reference Marks:

Note: For further information, contact the Douglas County Surveyor's Office, Room 205
 Douglas County Justice Building, Roseburg, OR 97470. Phone 440-4278. Douglas
 County resident outside the Roseburg calling area, dial toll free 1-800-452-0991.