

OFFICE OF THE  
DOUGLAS COUNTY SURVEYOR

Station: MAY AZIMUTH T 29 S, R 3 W , Sec 33

Set By (Agency): DCSO

Date Set: 1978

Recovered By RS, PB

Date Recovered 10/26/83

Recovered By \_\_\_\_\_

Date Recovered \_\_\_\_\_

Recovered By \_\_\_\_\_

Date Recovered \_\_\_\_\_

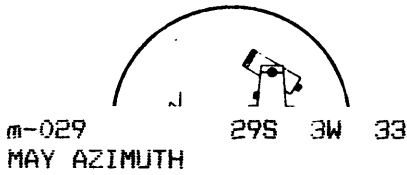
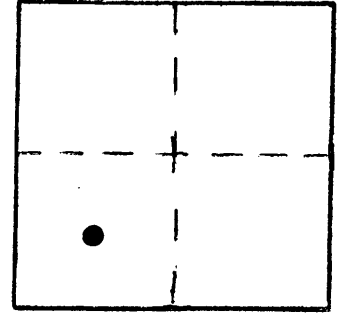

NAD 497520.87 4233055.87  
83 43° 0'10" 123° 4'24"

VERTICAL CONTROL

Elevation: \_\_\_\_\_ NGS Line # \_\_\_\_\_ USGS Line # \_\_\_\_\_ OSHD Line # \_\_\_\_\_

Precision: \_\_\_\_\_ Agency: \_\_\_\_\_ Proj. # \_\_\_\_\_ Date: \_\_\_\_\_

HORIZONTAL CONTROL **OCS 27**

South Zone State Plane Coordinates: Y(Northing) 497,556.94 X(Easting) 1,312,097.36

Precision: 1/50,000 Agency: DCSO Proj. # 2010-5(CS 60/32) Date: 1978

Approximate Geographic Position: Latitude 43°00'11" Longitude 123°04'20"

DESCRIPTION and TO REACH

SKETCH

DESCRIPTION:

A disk stamped "MAY AZIMUTH 1978" set in a 6"x36" concrete filled tile flush with ground.

TO REACH:

From the intersection of Co. Rd. #34 (Days Creek Rd.) and State Hwy #227 in T30S,R4W,Sec.10; proceed northeasterly along Co.Rd.#34 5.55 miles to monument on left.

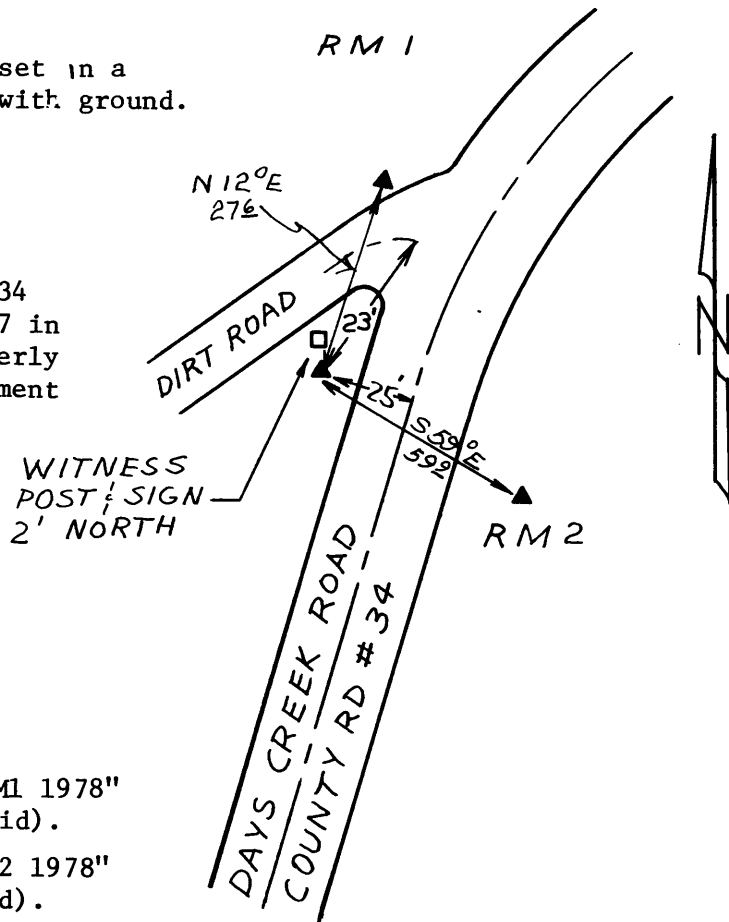

Reference Marks:

A DCSO disk stamped "MAY AZIMUTH RM1 1978" bears N 13°30'49" E, 27.60 ft. (grid).

A DCSO disk stamped "MAY AZIMUTH RM2 1978" bears S 57°09'53" E, 59.92 ft. (grid).

Note: For further information, contact the Douglas County Surveyor's Office, Room 205 Douglas County Justice Building, Roseburg, OR 97470. Phone 440-4278. Douglas County residents outside the Roseburg calling area, dial toll free 1-800-452-0991.