

OFFICE OF THE
DOUGLAS COUNTY SURVEYOR

Station: MAY T 29 S, R 3W, Sec 33

Set By (Agency): DCSO

Date Set: 1978

Recovered By RS, PB

Date Recovered 10/26/83

Recovered By _____

Date Recovered _____

Recovered By _____

Date Recovered _____

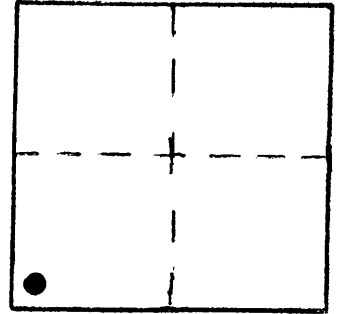

m-028
MAY 29S 3W 33

NAD 496286.22 4232249.05
83 42°59'58" 123° 4'34"

VERTICAL CONTROL

Elevation: _____ NGS Line # _____ USGS Line # _____ OSHD Line # _____

Precision: _____ Agency: _____ Proj. # _____ Date: _____

HORIZONTAL CONTROL **OCS 27**

South Zone State Plane Coordinates: Y(Northing) 496,322.28 X(Easting) 1,311,290.55

Precision: 1/50,000 Agency: DCSO Proj. # 2010-5(CS 60/32) Date: 1978

Approximate Geographic Position: Latitude 42°59'58" Longitude 123°04'30"

DESCRIPTION and TO REACH

SKETCH

DESCRIPTION:

A disk stamped "MAY 1978" set in a 6"x36" concrete filled tile 6 in. below ground.

TO REACH:

From the intersection of Co. Rd. #34 (Days Creek Rd.) and State Hwy #227 in T30S,R4W,Sec.10; proceed northeasterly along Co. Rd. #34 5.25 miles to monument on right.

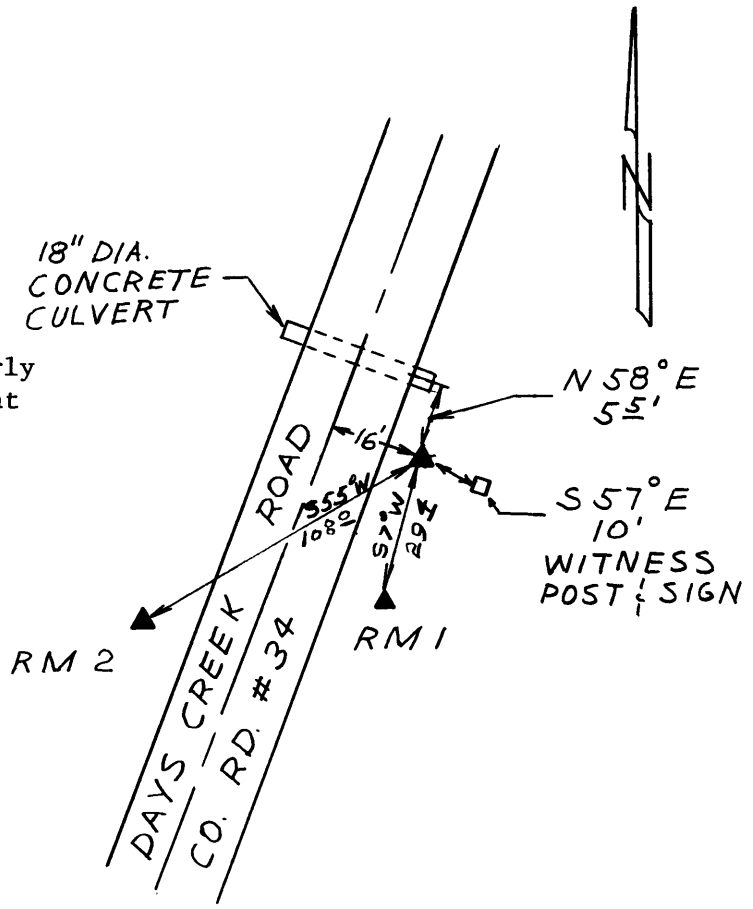

Reference Marks:

A DCSO disk stamped "MAY RM1 1978" bears S 8°43'35" W, 29.40 ft. (grid)

A DCSO disk stamped "MAY RM2 1978" bears S 57°19'09" W, 108.02 ft. (grid)

Note: For further information, contact the Douglas County Surveyor's Office, Room 205 Douglas County Justice Building, Roseburg, OR 97470. Phone 440-4278. Douglas County residents outside the Roseburg calling area, dial toll free 1-800-452-0991.