

OFFICE OF THE
DOUGLAS COUNTY SURVEYOR

M - 003

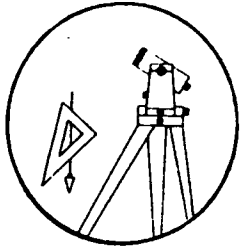

Station: M-432 T 32 S, R 6W, Sec 35

Set By (Agency): OSHD

Date Set: 1948

Recovered By JP-RWS

Date Recovered 2-4-82

Recovered By _____

Date Recovered _____

Recovered By _____

Date Recovered _____

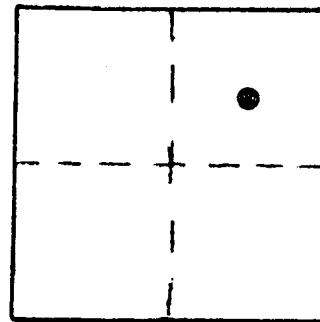

VERTICAL CONTROL CORPSCON6 NAVD88 1448.63 FT.

Elevation: 1445.253 NGS Line # _____ USGS Line # _____ OSHD Line # 310

Precision: 3rd Agency: OSHD Proj. # _____ Date: 1956

HORIZONTAL CONTROL

South Zone State Plane Coordinates: Y(Northing) 407719 X(Easting) 4149946

Precision: G/S SCALED Agency: DCSO Proj. # _____ Date: 2014

Approximate Geographic Position: Latitude _____ Longitude _____

DESCRIPTION and TO REACH

SKETCH

Found: A standard OSHD disk marked "M432 1948".
said disk is set flush on bridge abutment.

To reach: From I-5 exit 80 and Junction with
Fortune Branch access Rd, proceed Northerly
along Fortune Branch access Rd. 0.2 miles to
station M 432. Station is on the right on
the North East corner of bridge.

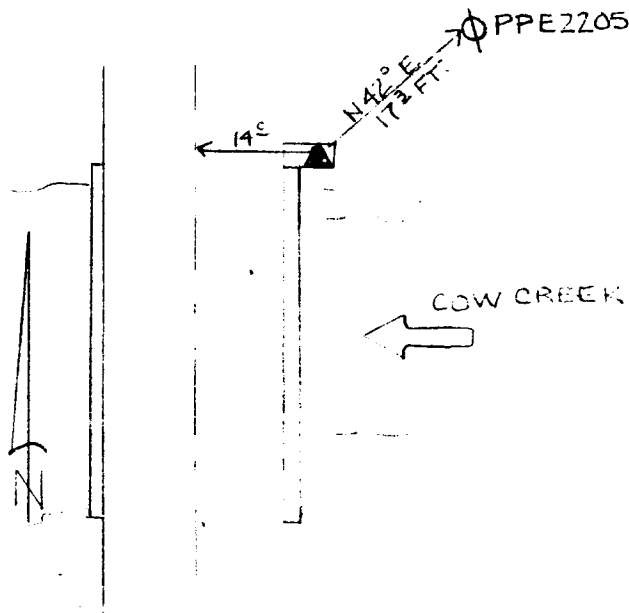

Reference Marks:

Note: For further information, contact the Douglas County Surveyor's Office, Room 205
Douglas County Justice Building, Roseburg, OR 97470. Phone 440-4278. Douglas
County residents outside the Roseburg calling area, dial toll free 1-800-452-0991.