

OFFICE OF THE  
DOUGLAS COUNTY SURVEYOR

L-060

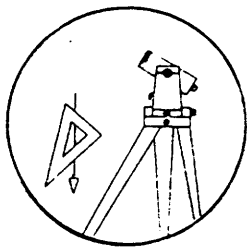

Station: LUTS-4 T 22 S, R 9 W, Sec 8  
Set By (Agency): DCSO  
Date Set: June, 1988  
Recovered By RWS,SJF  
Date Recovered 6/24/88  
Recovered By \_\_\_\_\_  
Date Recovered \_\_\_\_\_  
Recovered By \_\_\_\_\_  
Date Recovered \_\_\_\_\_

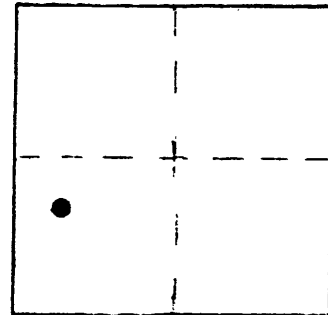

VERTICAL CONTROL

Elevation: 210.542 ft. NGS Line # \_\_\_\_\_ USGS Line # \_\_\_\_\_ OSHD Line # \_\_\_\_\_

Precision: 2nd order Agency: DCSO Proj. # 2007 Date: 1988

HORIZONTAL CONTROL CORPSCON6 NAVD88 214.119 FT.

South Zone State Plane Coordinates: Y(Northing) 746944 X(Easting) 4048167

Precision: GIS SCALED Agency: DCSO Proj. # \_\_\_\_\_ Date: 2014

Approximate Geographic Position: Latitude \_\_\_\_\_ Longitude \_\_\_\_\_

DESCRIPTION and TO REACH

SKETCH

A DCSO disk stamped "LUTS-4 1988" set in top of a 3 foot diameter, 2 foot high boulder at southerly side of Rd.

TO REACH:

From the intersection of State Highway 38 and Lutsinger Creek Rd. in T22S,R9W,Sec.18, proceed easterly along Lutsinger Creek Rd. approximately 2.4 miles to monument on right.

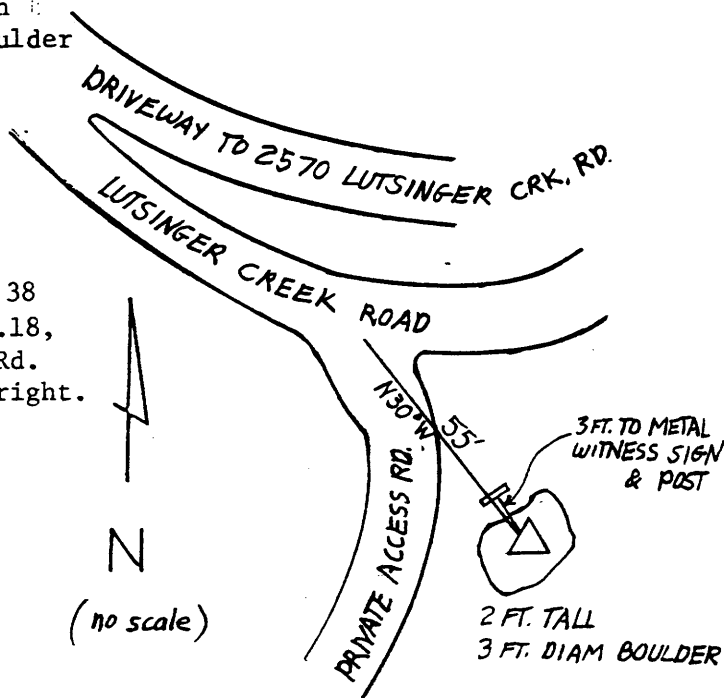

Reference Marks:

Note: For further information, contact the Douglas County Surveyor's Office, Room 205 Douglas County Justice Building, Roseburg, OR 97470. Phone 440-4278. Douglas County residents outside the Roseburg calling area, dial toll free 1-800-452-0991.