

Station: LOMB

T 27 S, R 5W, Sec 20

Date Set: 1998

L-077

Set By (Agency): DCSO

Date Recovered: 7-14-98

Recovered By: RWS SJF

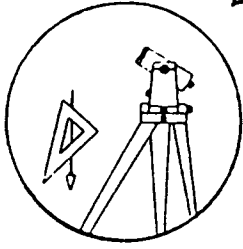

- Found
- New
- Reset
- Not Found
- Referenced
- Destroyed

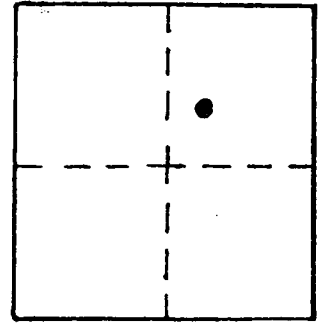

VERTICAL CONTROL

Elevation: 480.39 NGS Line # _____ USGS Line # _____ OSHD Line # _____
 Precision: 3rd Agency: DCSO Proj. # 66157 Date: 1998
 Proj. # 2007

HORIZONTAL CONTROL CORPSCON6 NAVDBB 483.90 FT.

South Zone O.C.S. 27: Y(Northing) _____ X(Easting) _____
 South Zone O.C.S. 83: Y(Northing) 575149 X(Easting) 4171728
 Precision: GIS SCALED Agency: DCSO Proj. # _____ Date: 2014
 Approx. ~~NAD 83~~ Geographic Position: Latitude 43 12 37 Longitude 123 18 39
 27

DESCRIPTION and TO REACH

INSURFACE OF THE CONCRETE CURB
A 3 INCH DIAMETER DCSO DRILL CAP SET FLUSH OF AN APPROXIMATELY
2 X 2 FOOT STORM SEWER DRAIN.

GO TO THE INTERSECTION OF DOUGLAS AVENUE (Co. Rd. # 4A) AND
LOMBARDY DRIVE IN T27S, R5W, SEC 20; MONUMENT LIES IN
NORTHEAST CORNER OF INTERSECTION.

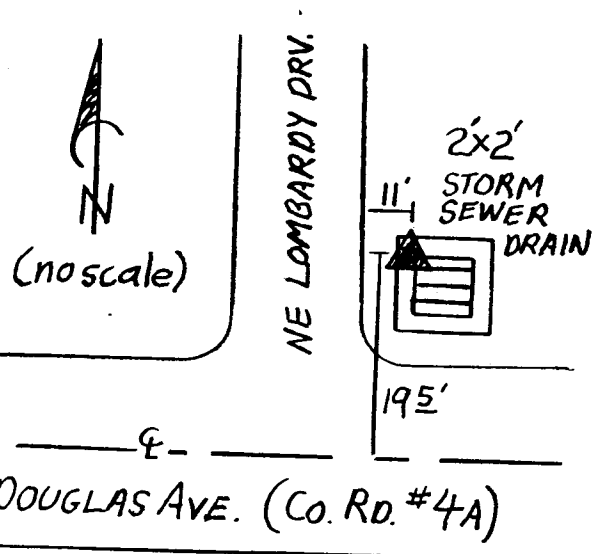

Reference Marks: