

OFFICE OF THE
DOUGLAS COUNTY SURVEYOR
L-063

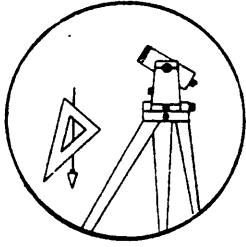

Station: LUTS-7 T 22 S, R 9 W , Sec 16
Set By (Agency): DCSO
Date Set: 1988
Recovered By RWS, SIF
Date Recovered 6/24/88
Recovered By _____
Date Recovered _____
Recovered By _____
Date Recovered _____

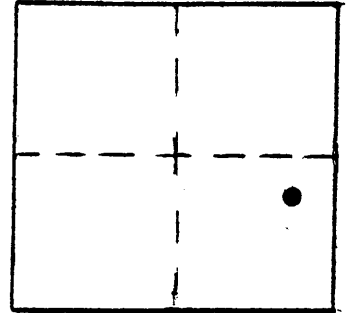

VERTICAL CONTROL NGVD 29

Elevation: 70.420 NGS Line # _____ USGS Line # _____ OSHD Line # _____
Precision: 2nd Agency: DCSO Proj. # 2007 Date: 1988

HORIZONTAL CONTROL

South Zone State Plane Coordinates: Y(Northing) _____ X(Easting) _____
Precision: _____ Agency: _____ Proj. # _____ Date: _____
Approximate Geographic Position: Latitude _____ Longitude _____

DESCRIPTION and TO REACH

A DCSO drill cap stamped "LUTS-7 1988" set in top of a 2 ft. triangular shaped lft. high rock outcrop.

TO REACH:

From the intersection of State Highway 138 and Lutsinger Creek Rd. in T22S,R9W,Sec.18, (near southerly end of bridge over Umpqua river at Scottsburg) proceed easterly along Lutsinger Crk. Rd. 5.0 miles to monument on right.

SKETCH

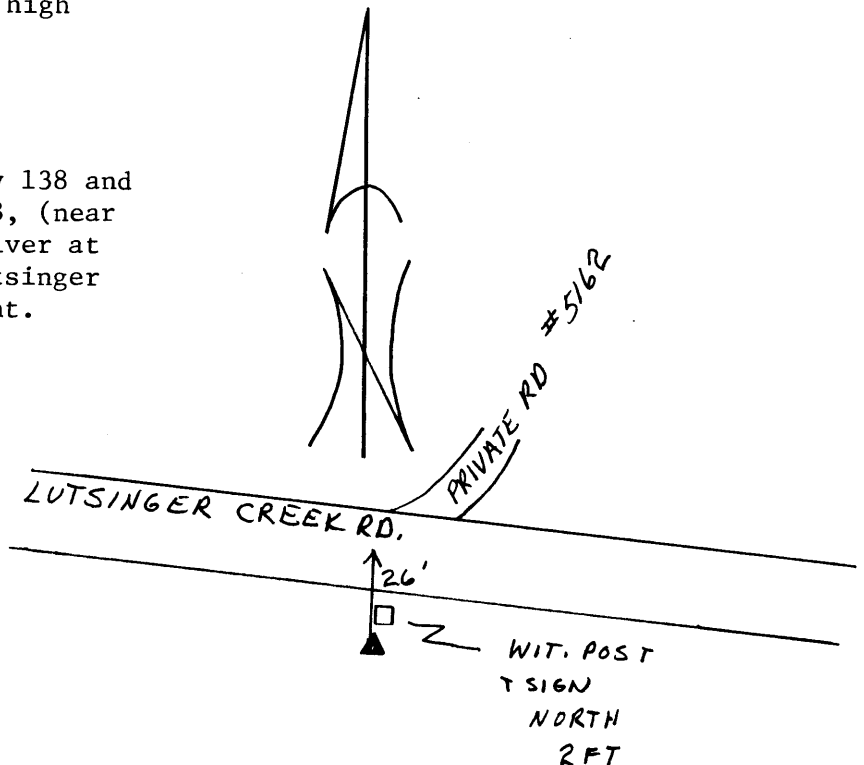

Reference Marks:

Note: For further information, contact the Douglas County Surveyor's Office, Room 205 Douglas County Justice Building, Roseburg, OR 97470. Phone 440-4278. Douglas County residents outside the Roseburg calling area, dial toll free 1-800-452-0991.