

OFFICE OF THE
DOUGLAS COUNTY SURVEYOR

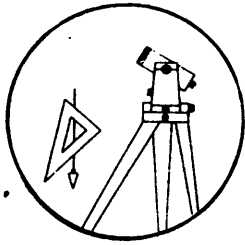

L-056

Station: LAMKA T 27 S, R 6 W , Sec 22
 Set By (Agency): R.L.S.# 536
 Date Set: 1987
 Recovered By RWS,SJF
 Date Recovered 12/30/87
 Recovered By _____
 Date Recovered _____
 Recovered By _____
 Date Recovered _____

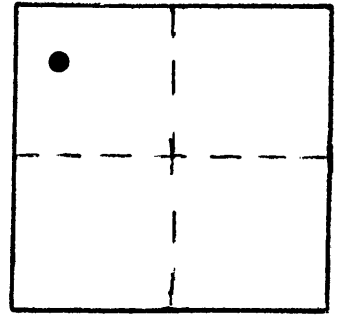

VERTICAL CONTROL **NGVD 29**

Elevation: 425.441 NGS Line # _____ USGS Line # _____ OSHD Line # _____
 Precision: 2nd Agency: DCSO Proj. # 2007 Date: 1990

HORIZONTAL CONTROL

South Zone State Plane Coordinates: Y(Northing) _____ X(Easting) _____
 Precision: _____ Agency: _____ Proj. # _____ Date: _____
 Approximate Geographic Position: Latitude _____ Longitude _____

DESCRIPTION and TO REACH

A 2 in. dia. disk stamped "LAMKA T.B.M. EL 425.49 1987 L.S. 536" set in an 8 in. dia. concrete filled concrete tile, protruding 2 in. above ground.

TO REACH:

From the intersection of Old Melrose Rd. (Co.Rd.#13) and Goedeck Rd. in T27S,R6W,Sec.22 (Roseburg) proceed northwesterly along Old Melrose Rd. 0.35 miles to monument on right.

SKETCH

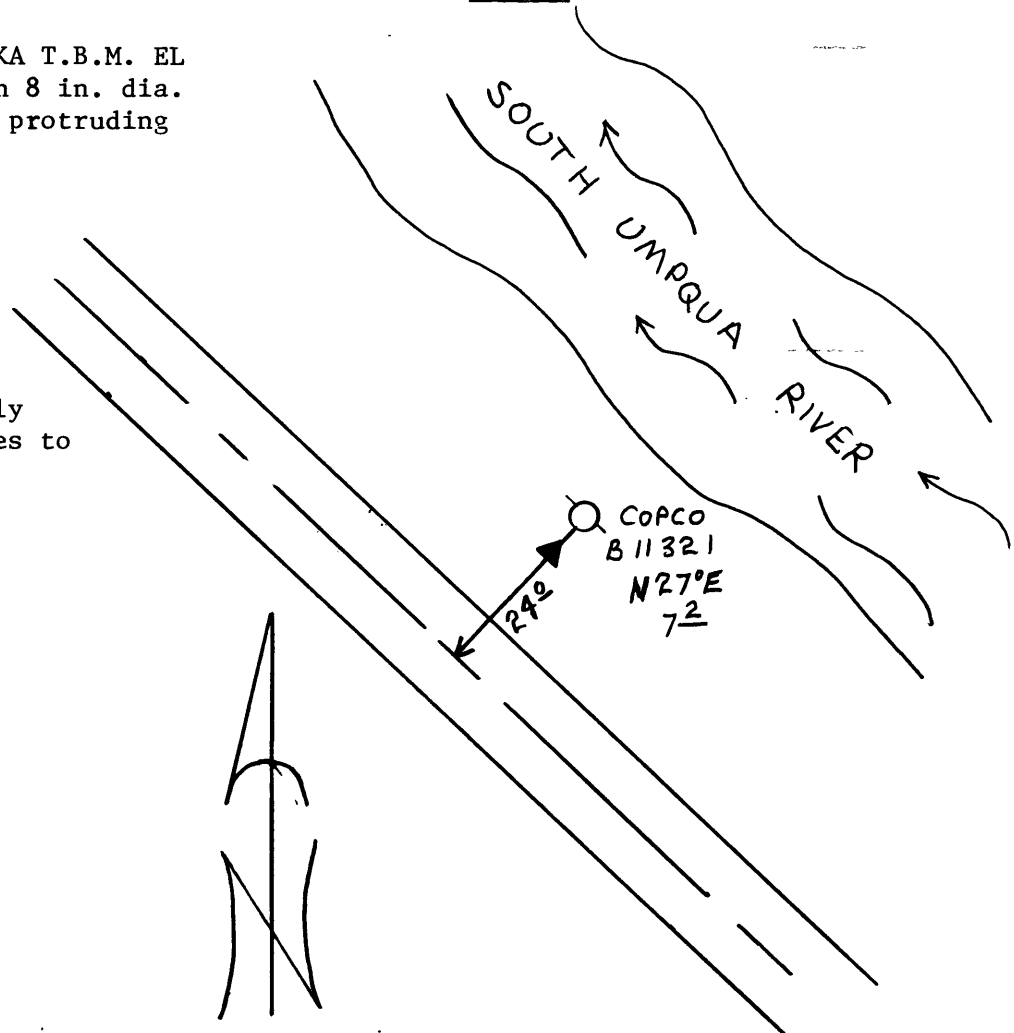

Reference Marks:

Note: For further information, contact the Douglas County Surveyor's Office, Room 205 Douglas County Justice Building, Roseburg, OR 97470. Phone 440-4278. Douglas County residents outside the Roseburg calling area, dial toll free 1-800-452-0991.