

OFFICE OF THE  
DOUGLAS COUNTY SURVEYOR

Station: LUM T 27 S, R 5 W, Sec 20  
 Set By (Agency): DCSO  
 Date Set: 1979  
 Recovered By JP,RS  
 Date Recovered 8/10/83  
 Recovered By \_\_\_\_\_  
 Date Recovered \_\_\_\_\_  
 Recovered By \_\_\_\_\_  
 Date Recovered \_\_\_\_\_

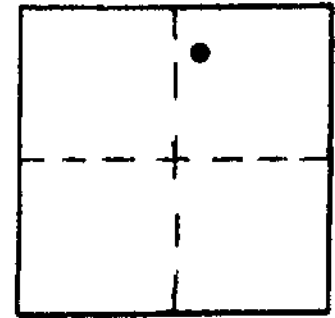

1-049  
LUM

27S 5W 20

NAD 83 576191.60 4171518.07  
 43°12'47" 123°18'47"

VERTICAL CONTROL

Elevation: \_\_\_\_\_ NGS Line # \_\_\_\_\_ USGS Line # \_\_\_\_\_ OSHD Line # \_\_\_\_\_  
 Precision: \_\_\_\_\_ Agency: \_\_\_\_\_ Proj. # \_\_\_\_\_ Date: \_\_\_\_\_

HORIZONTAL CONTROL *OCS 27*

South Zone State Plane Coordinates: Y(Northing) 576,226.87 X(Easting) 1,250,559.75  
 Precision: 1/25,000 Agency: DCSO Proj. # 2008 Date: 1980  
 Approximate Geographic Position: Latitude 43°12'48" Longitude 123°18'43"

DESCRIPTION and TO REACH

SKETCH

DESCRIPTION:

A 5/8 in. Iron Rod with alum. cap stamped "LUM 1979".

TO REACH:

From the intersection of Patterson St. and Co. Rd. #4 (Diamond Lake Blvd.) proceed easterly along Co. Rd. #4 approx. 200 ft. to station on left. Station lies 6.0 ft. north from 25 ft. high cut bank.

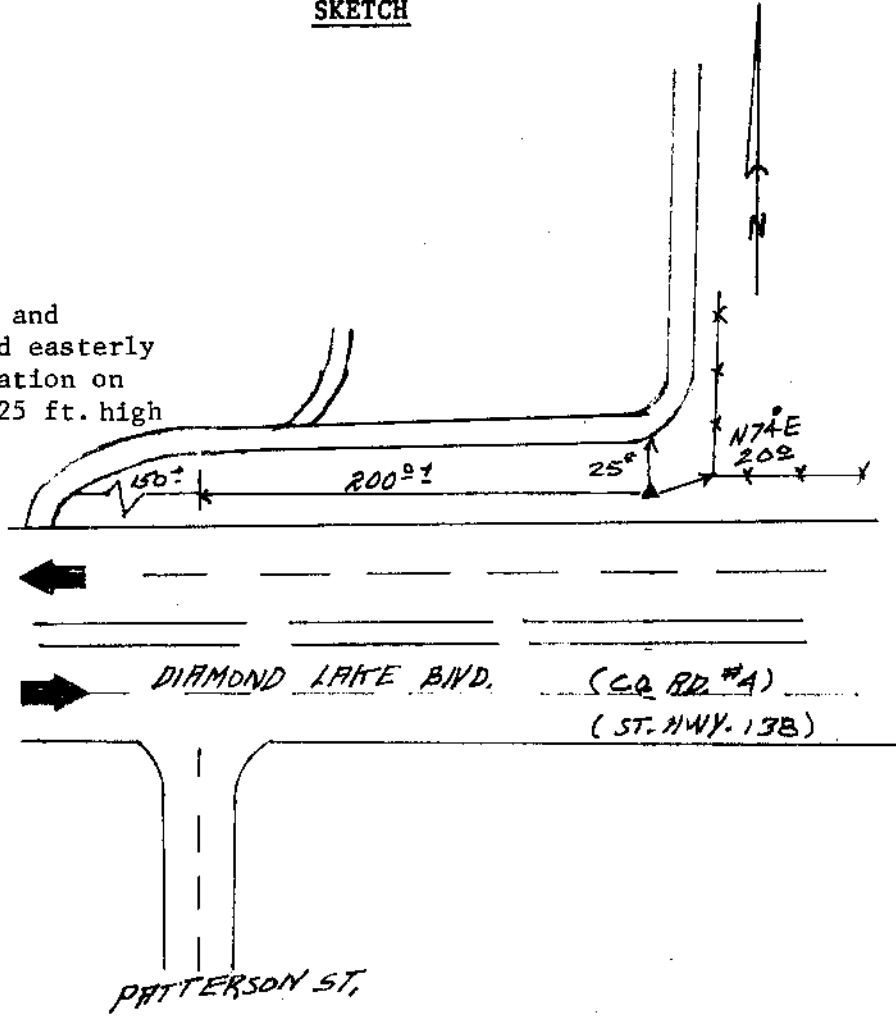

Reference Marks:

Note: For further information, contact the Douglas County Surveyor's Office, Room 205 Douglas County Justice Building, Roseburg, OR 97470. Phone 440-4278. Douglas County residents outside the Roseburg calling area, dial toll free 1-800-452-0991.