

OFFICE OF THE
DOUGLAS COUNTY SURVEYOR

Station: LEDGE T 28 S, R 6 W , Sec 16

Set By (Agency): Don Garrett

Date Set: 1972 L.S. #0544

Recovered By SJF

Date Recovered April 27, 1984

Recovered By _____

Date Recovered _____

Recovered By _____

Date Recovered _____

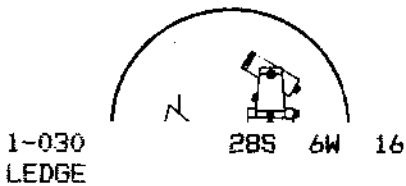
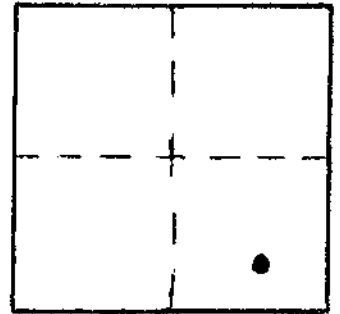

NAD 546983.13 4144588.45
83 43° 7'50" 123°24'37"

VERTICAL CONTROL N6VD29

Elevation: 644.02 ft. NGS Line # _____ USGS Line # _____ OSHD Line # _____

Precision: 3rd. Agency: Don Bentz Proj. # _____ Date: 1972
L.S. #0839

HORIZONTAL CONTROL OCS 27

South Zone State Plane Coordinates: Y(Northing) 547,018.27 X(Easting) 1,223,630.15

Precision: 1/25,000 Agency: DCSO Proj. # 2005 C.S. 56/9 Date: 1972

Approximate Geographic Position: Latitude 43°07'50" Longitude 123°24'33"

DESCRIPTION and TO REACH

A DCSO disk stamped "LEDGE 1972" cemented flush in a low rock outcrop measuring 3X7 ft.

TO REACH:

From the intersection of State Highway 99 and Lookingglass Rd. (Co. Rd. #107) in T28S,R6W,Sec.15, proceed on foot to monument which lies N33°W, approximately 900 ft. distant.

SKETCH

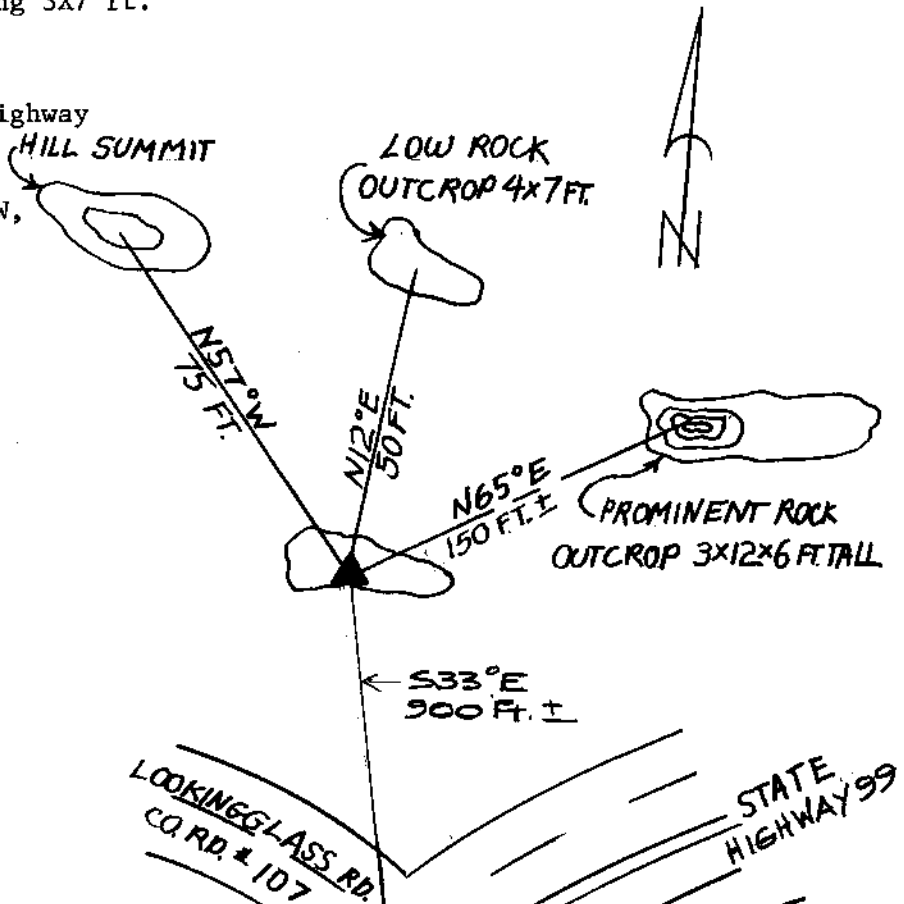

Reference Marks:

Note: For further information, contact the Douglas County Surveyor's Office, Room 205 Douglas County Justice Building, Roseburg, OR 97470. Phone 440-4278. Douglas County residents outside the Roseburg calling area, dial toll free 1-800-452-0991.